

Sunshine

designed by Tessie Fay

featuring the Pink Lemonade fabric collection by Tessie Fay

QUILT SIZE: 55" x 77"

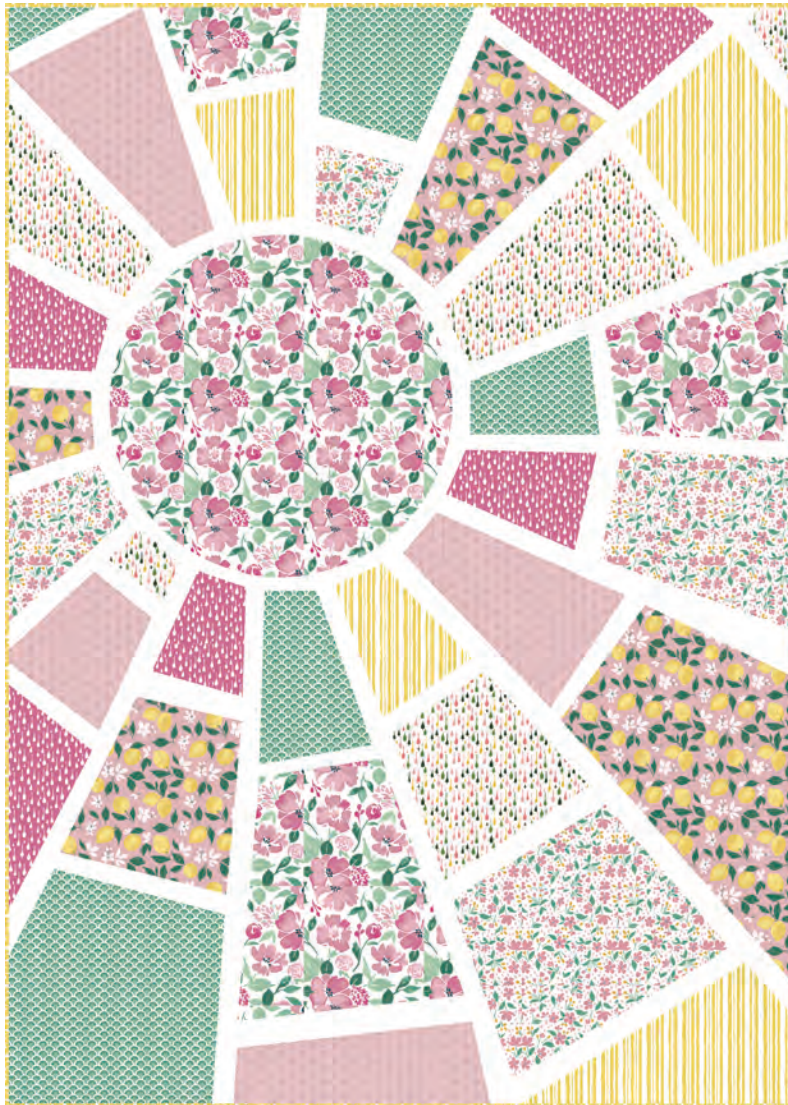









THIS IS A DIGITAL REPRESENTATION OF THE QUILT TOP, FABRIC MAY VARY.

FREE
PROJECT

PLEASE NOTE: BEFORE MAKING YOUR PROJECT, CHECK FOR ANY PATTERN UPDATES AT WINDHAMFABRICS.COM'S FREE PROJECTS SECTION.



Sunshine

KEY	FABRIC	SKU	YD	CUTTING INSTRUCTIONS
A		51321-2 white	1-1/3	<ul style="list-style-type: none"> • See instructions to cut (1) Template 3 trapezoid. • See instructions to cut (1) Template 12 trapezoid. • See instructions to cut (1) Template 23 trapezoid. • See instructions to cut (1) Template 35 circle.
B		51326-4 light pink	2/3	<ul style="list-style-type: none"> • See instructions to cut (1) Template 2 trapezoid. • See instructions to cut (1) Template 17 trapezoid. • See instructions to cut (1) Template 22 trapezoid. • See instructions to cut (1) Template 29 trapezoid.
C		51325-5 spearmint	1	<ul style="list-style-type: none"> • See instructions to cut (1) Template 1 triangle. • See instructions to cut (1) Template 5 trapezoid. • See instructions to cut (1) Template 13 trapezoid. • See instructions to cut (1) Template 24 trapezoid. • See instructions to cut (1) Template 25 trapezoid.
D		51327-3 lemon	3/4	<ul style="list-style-type: none"> • See instructions to cut (1) Template 4 trapezoid. • See instructions to cut (1) Template 10 trapezoid. • See instructions to cut (1) Template 18 trapezoid. • See instructions to cut (1) Template 21 trapezoid.
E		51323-2 white	1	<ul style="list-style-type: none"> • See instructions to cut (1) Template 6 trapezoid. • See instructions to cut (1) Template 14 trapezoid. • See instructions to cut (1) Template 19 trapezoid. • See instructions to cut (1) Template 31 trapezoid.
F		51322-4 light pink	1	<ul style="list-style-type: none"> • See instructions to cut (1) Template 8 trapezoid. • See instructions to cut (1) Template 16 trapezoid. • See instructions to cut (1) Template 26 trapezoid. • See instructions to cut (1) Template 32 trapezoid.
G		51324-6 dark pink	2/3	<ul style="list-style-type: none"> • See instructions to cut (1) Template 7 trapezoid. • See instructions to cut (1) Template 15 trapezoid. • See instructions to cut (1) Template 27 trapezoid. • See instructions to cut (1) Template 28 triangle. • See instructions to cut (1) Template 33 trapezoid.
H		51324-X multi	7/8	<ul style="list-style-type: none"> • See instructions to cut (1) Template 9 trapezoid. • See instructions to cut (1) Template 11 trapezoid. • See instructions to cut (1) Template 20 trapezoid. • See instructions to cut (1) Template 30 trapezoid. • See instructions to cut (1) Template 34 trapezoid.
I		35370S-1 optic white	3-3/4	<ul style="list-style-type: none"> • (2) 55-1/2" x WOF strips. Sew the strips together and trim to 55-1/2" x 77-1/2" to make the background strip.
J		51324-3 lemon	2/3	<p>Binding</p> <ul style="list-style-type: none"> • (7) 2-1/2" x WOF strips for the binding.
		Backing (Your Choice)	5	<ul style="list-style-type: none"> • (2) 85" x WOF strips. Sew the strips together and trim to 63" x 85" for the pieced back.
				Batting 63" x 85"



Sunshine

Project Disclaimer: Every effort has been made to ensure that all projects are error free. All the information is presented in good faith, however, no warranty can be given nor results guaranteed. Therefore, we assume no responsibility nor damages that may occur when referring to this pattern. When errors are brought to our attention, we make every effort to correct and post a revision as soon as possible. We suggest you check windhamfabrics.com for pattern updates and to test the pattern prior to making the project. **Test templates first, before cutting all the pieces.** Free projects are not for resale.

Quilt Top Assembly

(Refer to the Quilt Diagram while assembling the quilt top.)

1. Following the manufacturer's instructions, trace the listed number of each template onto the paper side of the fusible web. Roughly cut out each template about 1/8" outside the drawn lines.
2. Press each template onto the wrong side of the fabrics as listed on the templates. Cut out each template on the drawn lines.
3. Refer to the **Quilt Layout** to arrange and press the assorted shapes onto the **I** 55-1/2" x 77-1/2" background strip.
4. Finish the raw edges of each shape with a decorative stitch such as a buttonhole or satin stitch to make the quilt top.

Finishing

5. Layer and quilt as desired.
6. Sew the (7) **J** 2-1/2" x WOF strips together end-to-end with 45-degree seams to make the binding. Fold this long strip in half lengthwise with wrong sides together and press.
7. Bind as desired.



Sunshine

SIZE: 55" X 77"

Quilt Diagram

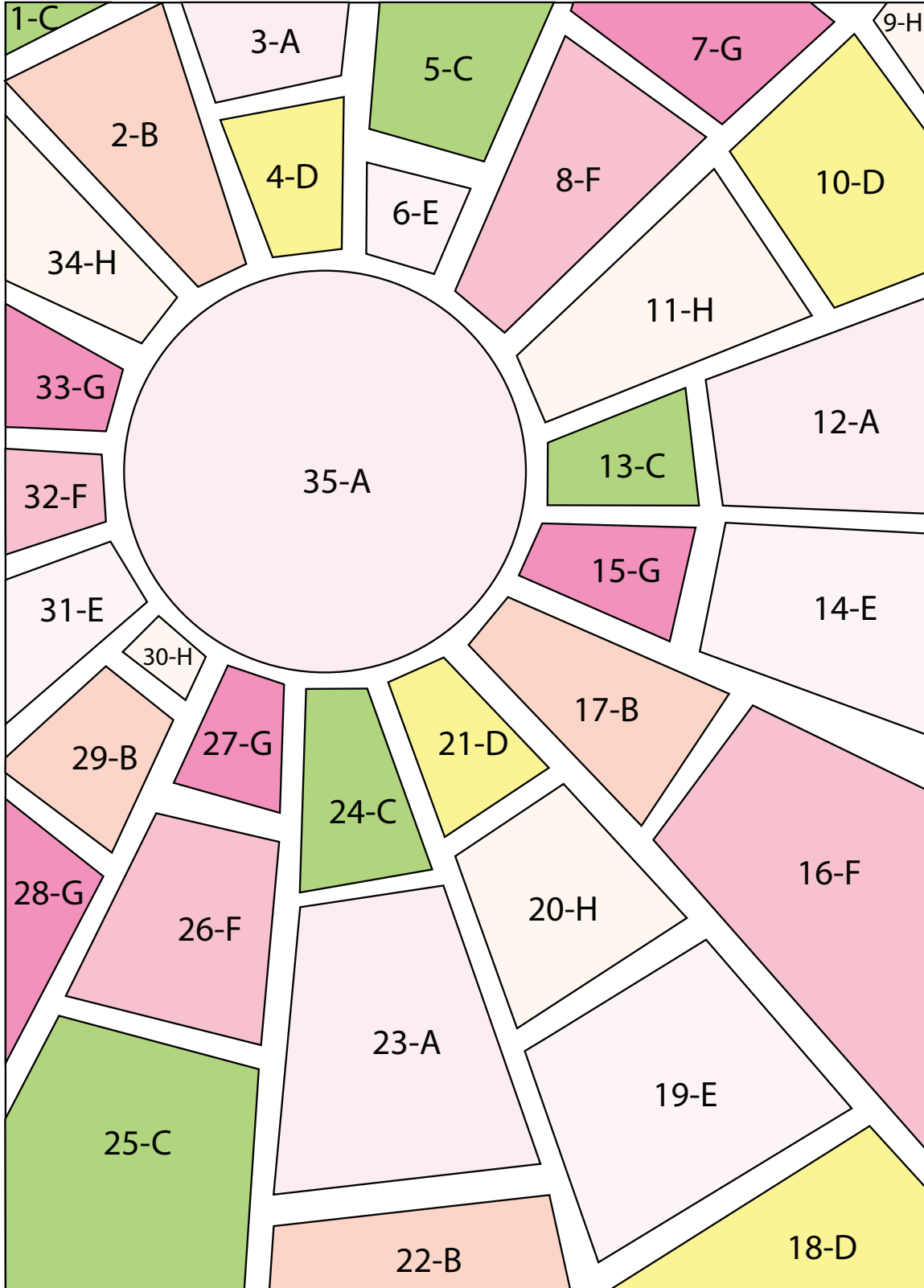



Templates

Sunshine

Test templates first, before cutting all the fabric pieces.

Reversed Templates
ENLARGE 400%



Square should
measure 1"
AFTER enlarging
templates 400%

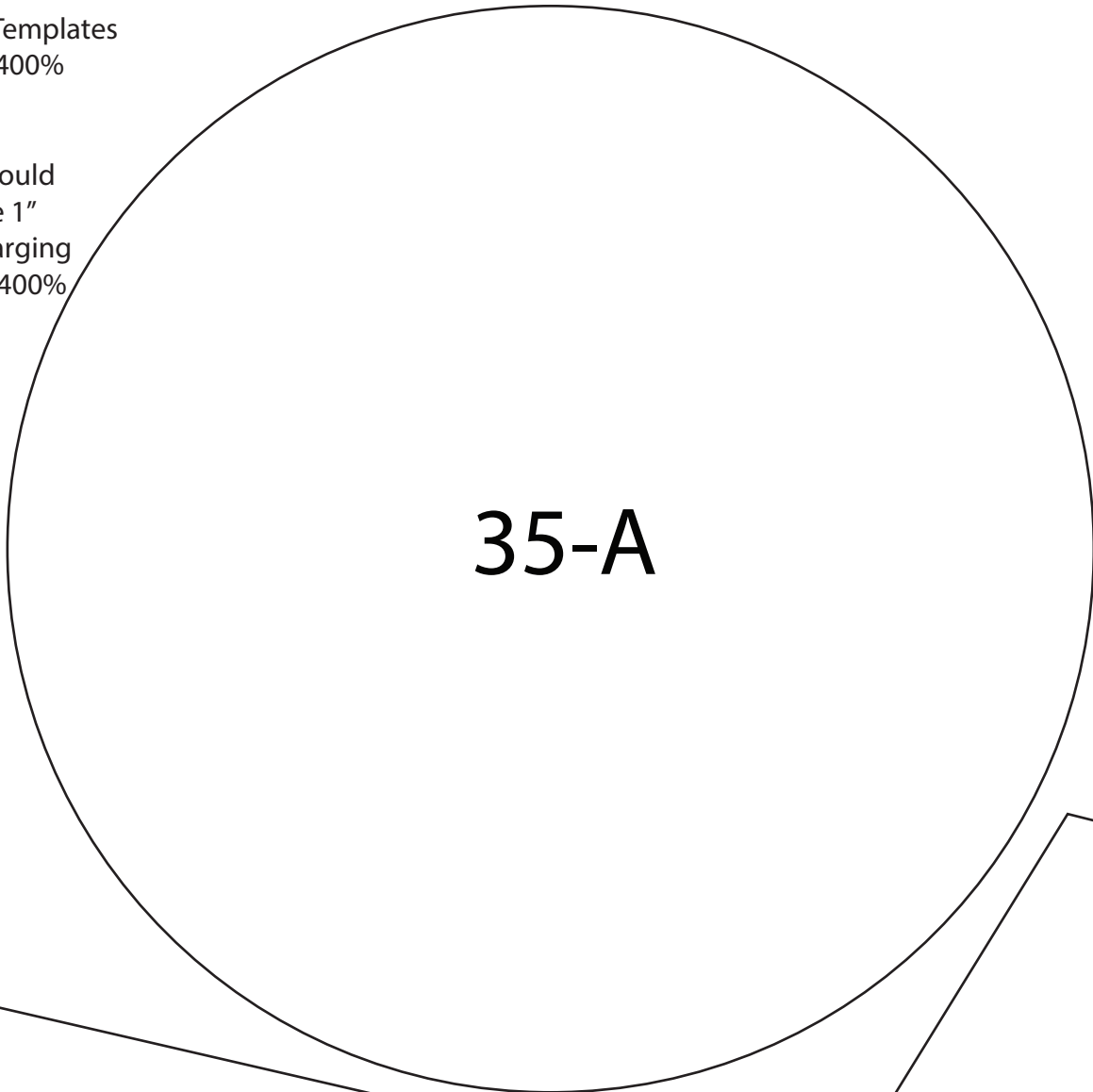

35-A

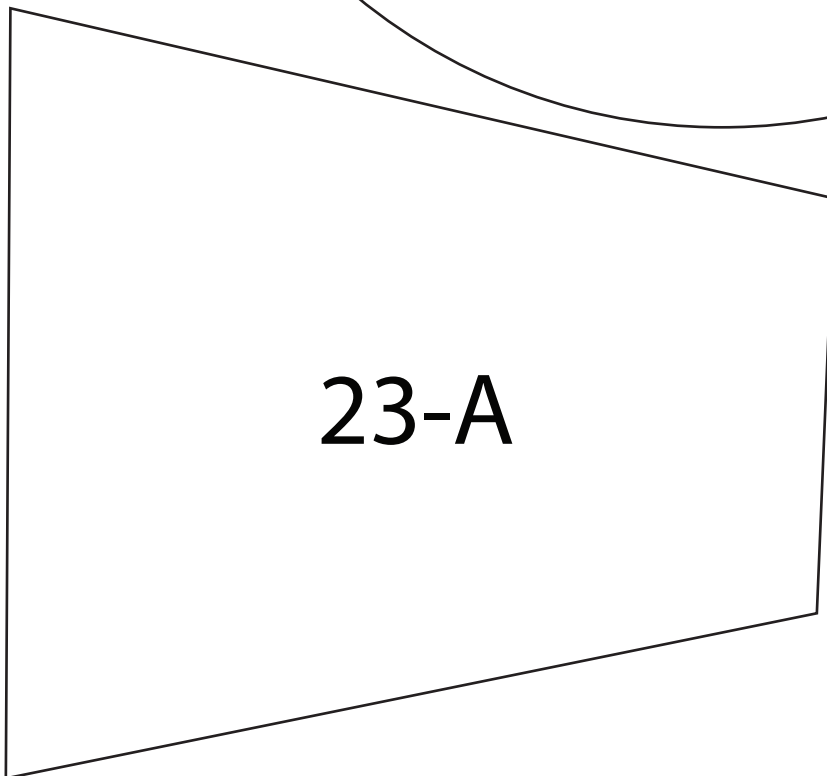

23-A

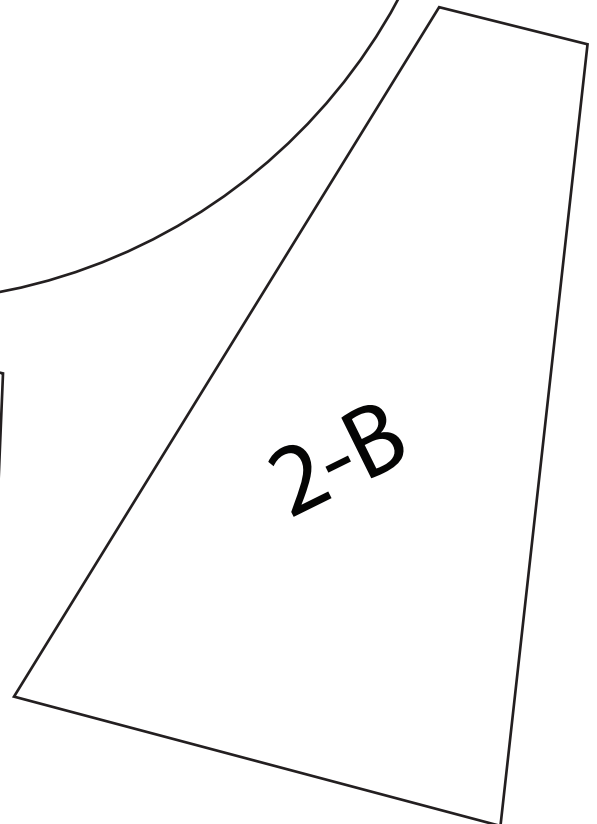

2-B



Templates

Sunshine

Test templates first, before cutting all the fabric pieces.

Reversed Templates
ENLARGE 400%



Square should
measure 1"
AFTER enlarging
templates 400%

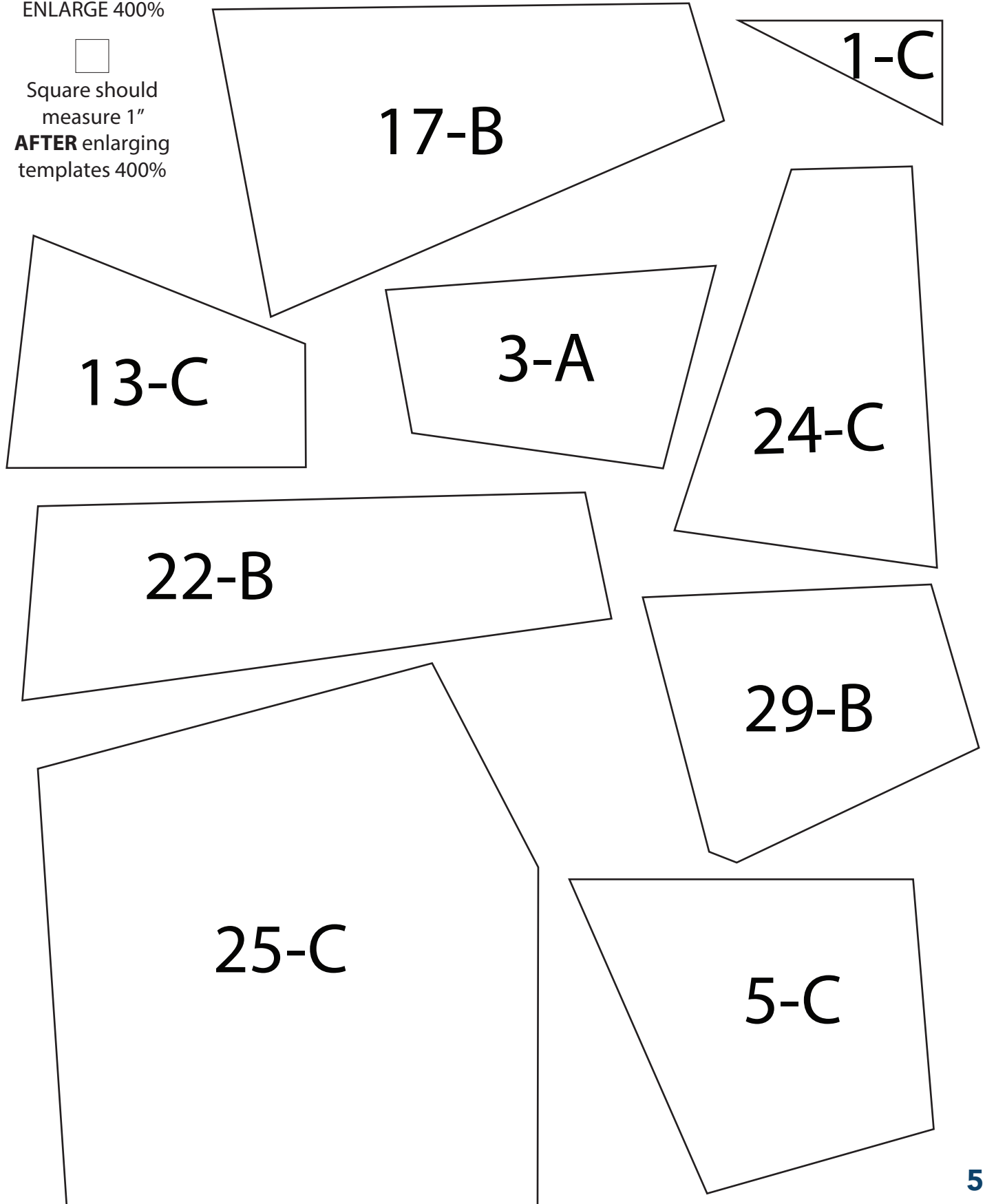



Templates

Sunshine

Test templates first, before cutting all the fabric pieces.

Reversed Templates
ENLARGE 400%



Square should
measure 1"

AFTER enlarging
templates 400%

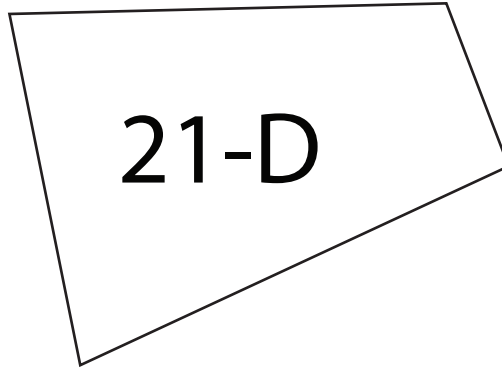

21-D

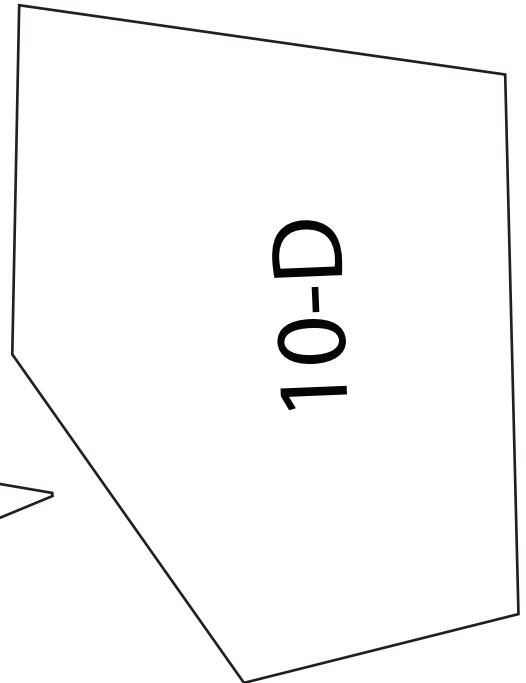

10-D



18-D

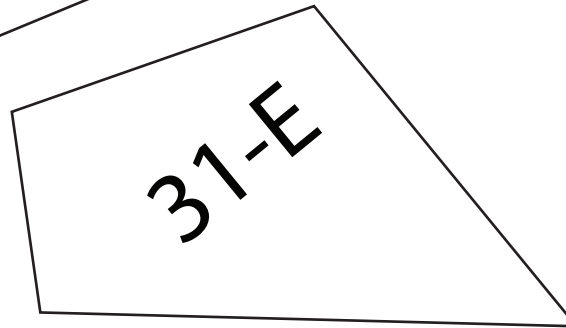

31-E

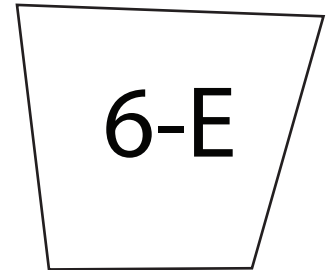

6-E

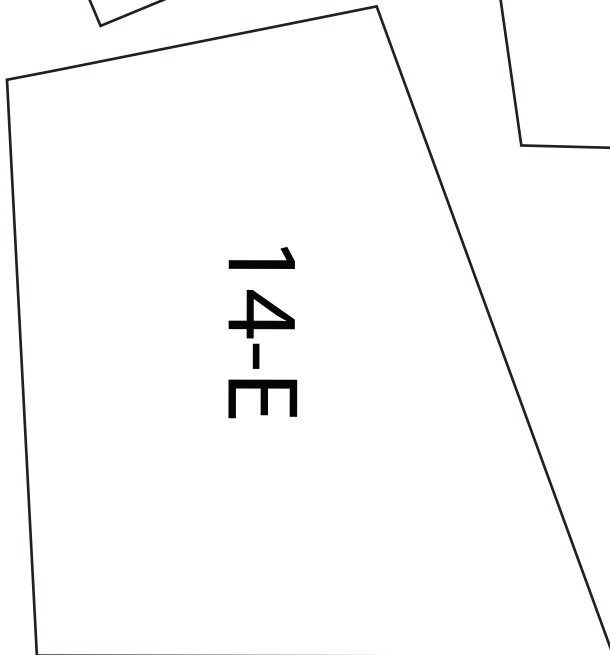

14-E

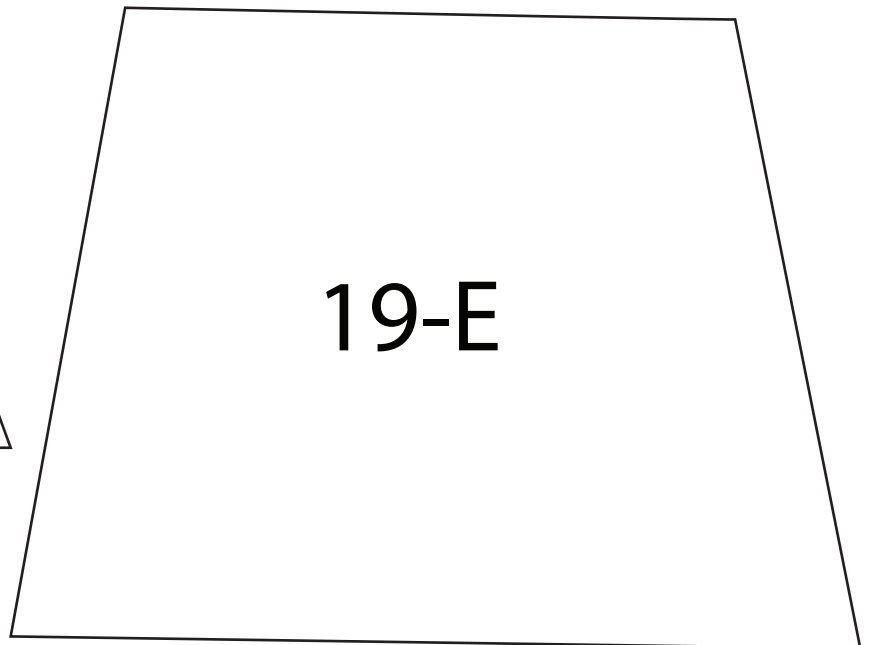

19-E



Templates

Sunshine

Test templates first, before cutting all the fabric pieces.

Reversed Templates
ENLARGE 400%



Square should
measure 1"

AFTER enlarging
templates 400%

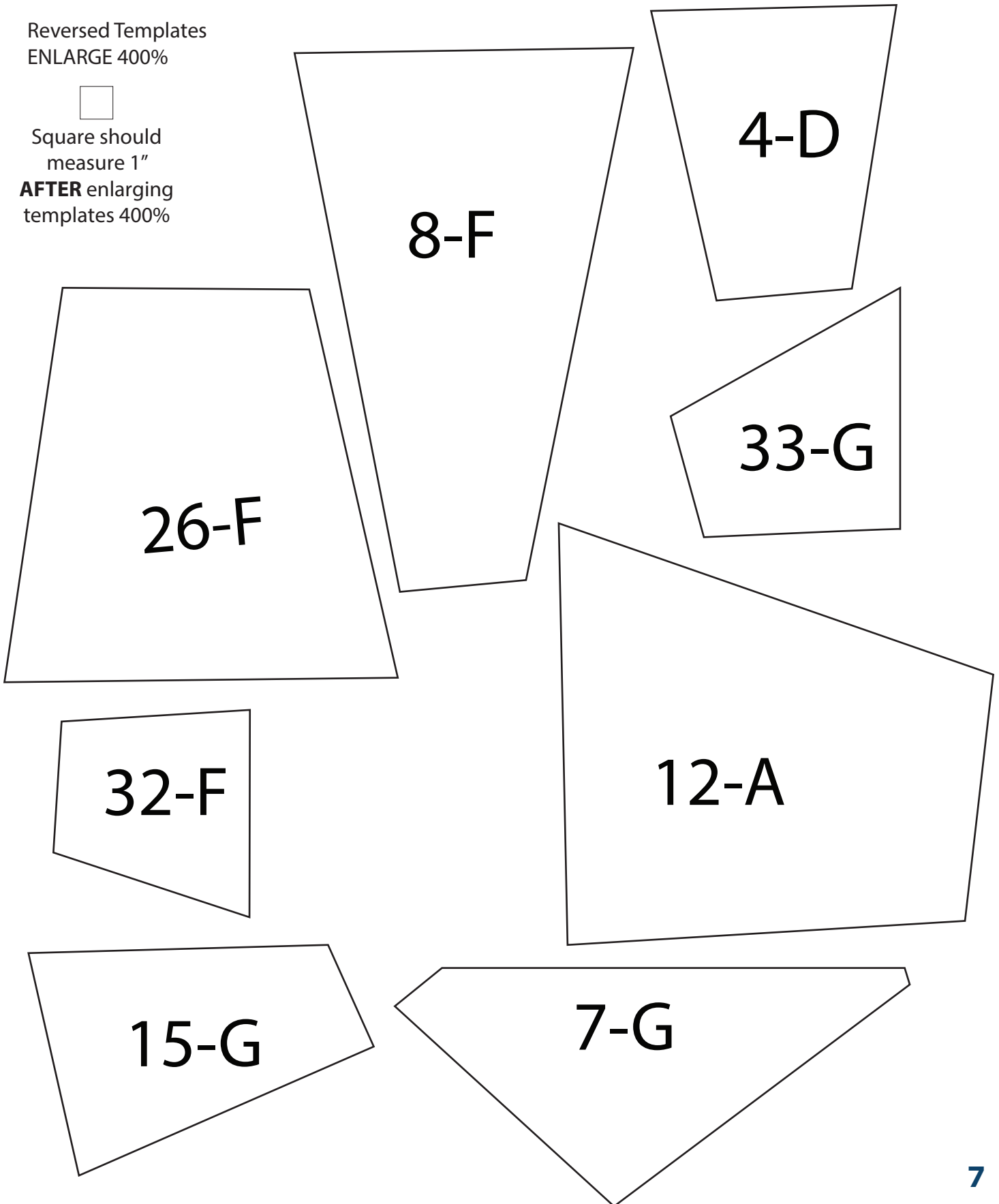



Templates

Sunshine

Test templates first, before cutting all the fabric pieces.

Reversed Templates
ENLARGE 400%



Square should
measure 1"

AFTER enlarging
templates 400%

