

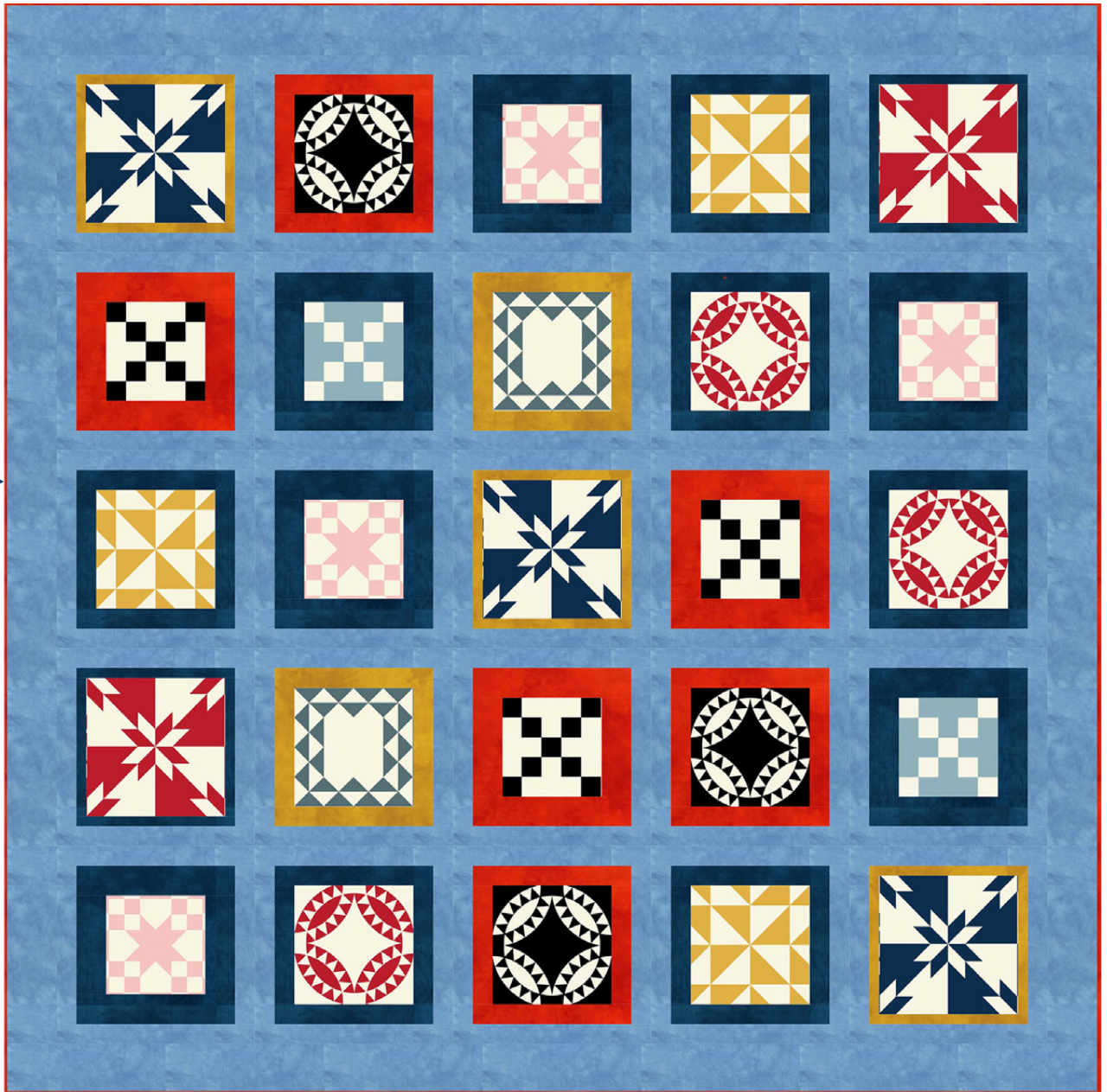

Medley

designed by Wendy Sheppard
featuring *Perfect Points* by Whistler Studios

SIZE: 55" x 55"



THIS IS A DIGITAL REPRESENTATION OF THE QUILT TOP, FABRIC MAY VARY.



PLEASE NOTE: BEFORE MAKING YOUR PROJECT, CHECK FOR ANY PATTERN UPDATES AT WINDHAMFABRICS.COM'S FREE PROJECTS SECTION.



Medley



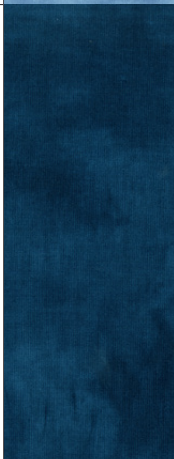

PROJECT DISCLAIMER: Every effort has been made to ensure that all projects are error free. All the information is presented in good faith, however, no warranty can be given nor results guaranteed. Therefore, we assume no responsibility nor damages that may occur when referring to this pattern. When errors are brought to our attention, we make every effort to correct and post a revision as soon as possible. We suggest you check windhamfabrics.com for pattern updates and to test the pattern prior to making the project. Test templates first, before cutting all the pieces. Free projects are not for resale.

WOF=WIDTH OF FABRIC

KEY	FABRIC	SKU	YD	CUTTING INSTRUCTIONS
A		PALETTE: 37098-6 Mustard	1/4	<p>BLOCK ONE (3) 1" x WOF strips. Subcut (6) 1" x 7-1/2" and (6) 1" x 8-1/2" rectangles.</p> <p>BLOCK TWO (2) 1-1/2" x WOF strips. Subcut (4) 1-1/2" x 6-1/2" and (4) 1-1/2" x 8-1/2" rectangles.</p>
B		PALETTE: 37098-16 Cherry	7/8	<p>BLOCK TWO (3) 1-1/2" x WOF strips. Subcut (6) 1-1/2" x 6-1/2" and (6) 1-1/2" x 8-1/2" rectangles.</p> <p>BLOCK THREE (3) 2" x WOF strips. Subcut (6) 2" x 5-1/2" and (6) 2" x 8-1/2" rectangles.</p> <p>BINDING (6) 2-1/4" x WOF strips. Sew strips via short ends.</p>
C		PALETTE: 37098-43 Giotto Blue	2	<p>PIECED BLOCKS (2) 8-1/2" x WOF strips. Subcut (50) 1-1/2" x 8-1/2" rectangles.</p> <p>(2) 10-1/2" x WOF strips. Subcut (50) 1-1/2" x 10-1/2" rectangles.</p> <p>OUTER BORDER (6) 3" x WOF strips. Piece strips and subcut (2) 3" x 50-1/2" and (2) 3" x 55-1/2" strips.</p>
D		PALETTE: 37098-64 Indigo	2/3	<p>BLOCK ONE (2) 1" x WOF strips. Subcut (4) 1" x 7-1/2" and (4) 1" x 8-1/2" rectangles.</p> <p>BLOCK TWO (5) 1-1/2" x WOF strips. Subcut (12) 1-1/2" x 6-1/2" and (12) 1-1/2" x 8-1/2" rectangles.</p> <p>BLOCK THREE (1) 8-1/2" x WOF strip. Subcut (12) 2" x 8-1/2" and (8) 2" x 5-1/2" rectangles.</p> <p>(1) 2" x WOF strip. Subcut (4) 2" x 5-1/2" rectangles.</p>



Medley

KEY	FABRIC	SKU	YD	CUTTING INSTRUCTIONS
FUSSY CUT FOLLOWING SQUARES (CENTERING DESIGN) AS INDICATED BELOW:				
E		54225-1 Black & White	1/4	BLOCK TWO: (3) 6-1/2" squares.
F		54225-2 Red	1/4	BLOCK TWO: (3) 6-1/2" squares.
G		54226-2 Red	1/4	BLOCK ONE: (2) 7-1/2" squares.
H		54226-3 Indigo	1/4	BLOCK ONE: (3) 7-1/2" squares.
I		54227-1 Black & White	1/4	BLOCK THREE: (3) 5-1/2" squares.
J		54227-4 Blue	1/4	BLOCK THREE: (2) 5-1/2" squares.
K		54228-5 Blush	1/4	BLOCK THREE: (4) 5-1/2" squares.
L		54229-6 Slate	1/4	BLOCK TWO: (2) 6-1/2" squares.
M		54230-7 Yellow	1/4	BLOCK TWO: (3) 6-1/2" squares.
		Backing	3-1/2	Batting 63" x 63"



Medley

BLOCK ASSEMBLY

1. A/H UNIT: Sew (1) **A** 1" x 7-1/2" rectangle to the opposite sides of (1) **H** 7-1/2" square, followed by (1) **A** 1" x 8-1/2" rectangle to the remaining opposite sides of **A/H** unit.

2. BLOCK ONE: Sew (1) **C** 1-1/2" x 8-1/2" rectangle to the opposite sides of **A/H** unit, followed by (1) **C** 1-1/2" x 10-1/2" rectangle to the remaining opposite sides to complete (1) Block One. Block measures 10-1/2" square unfinished.

3. Similar to **A/H/C** Block One formation make **G/D/C** Block One as shown below.

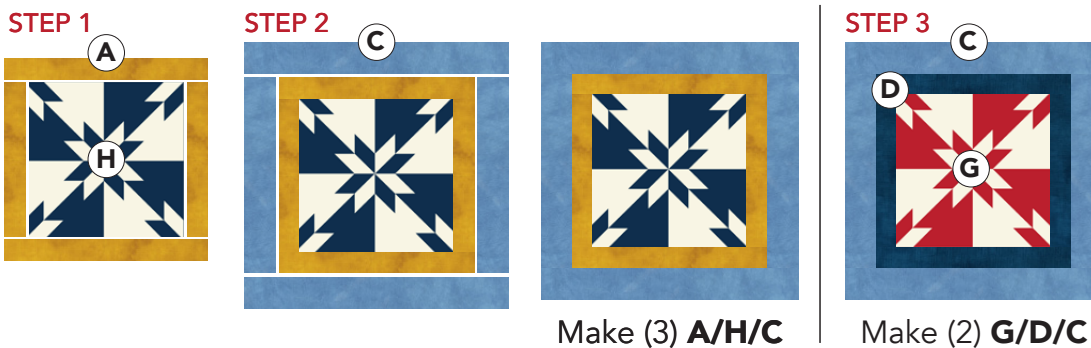

4. B/E UNIT: Sew (1) **B** 1-1/2" x 6-1/2" rectangle to the opposite sides of (1) **E** 6-1/2" square, followed by (1) **B** 1-1/2" x 8-1/2" rectangle to the remaining opposite sides of **B/E** unit.

5. BLOCK TWO: Sew (1) **C** 1-1/2" x 8-1/2" rectangle to the opposite sides of **B/E** unit, followed by (1) **C** 1-1/2" x 10-1/2" rectangle to the remaining opposite sides to complete Block Two. Block measures 10-1/2" square unfinished.

6. Similar to **E/B/C** Block Two formation, make the remaining Block Twos as shown below.

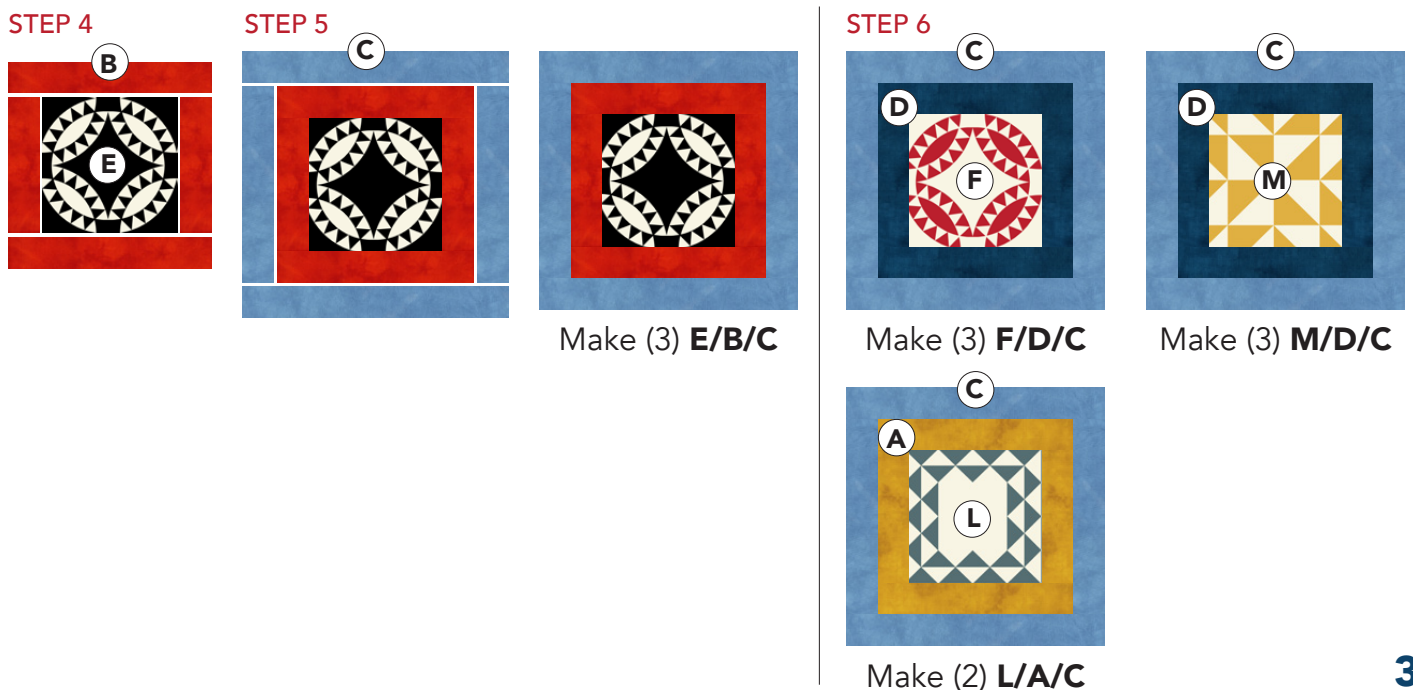



Medley

7. D/K UNIT: Sew (1) **D** 2" x 5-1/2" rectangle to the opposite sides of (1) **K** 5-1/2" square, followed by (1) **D** 2" x 8-1/2" rectangle to the remaining opposite sides of **D/K** unit.

8. BLOCK THREE: Sew (1) **C** 1-1/2" x 8-1/2" rectangle to the opposite sides of **D/K** unit, followed by (1) **C** 1-1/2" x 10-1/2" rectangle to the remaining opposite sides to complete Block Three. Block measures 10-1/2" square unfinished.

9. Similar to **D/K/C** Block Three formation make the remaining (2) Block Threes as shown below.

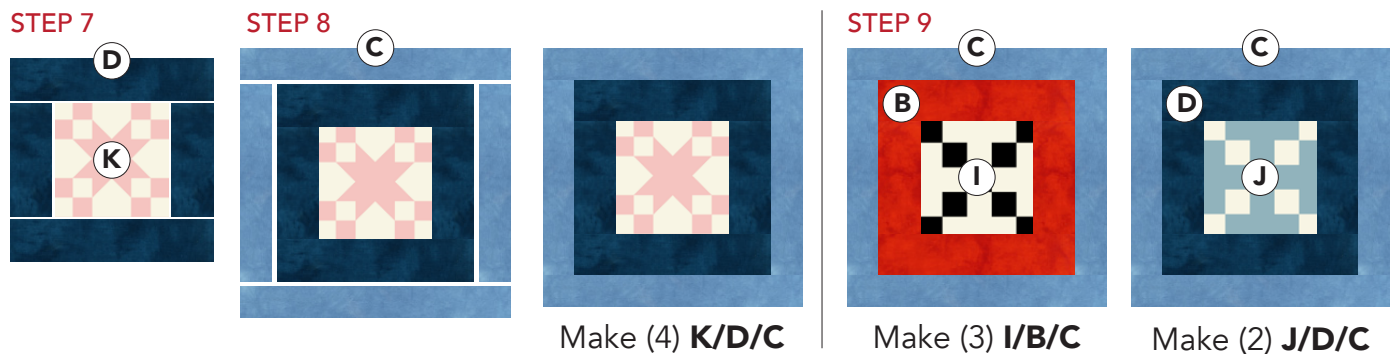

QUILT ASSEMBLY

Refer to Quilt Diagram on PG. 5 for proper placement of blocks and row assembly.

10. ROW ASSEMBLY: Arrange and sew together (5) blocks into (5) rows.

11. Sew together pieced rows to complete quilt center.

12. BORDER ASSEMBLY: Sew (1) **C** 3" x 50-1/2" strip to the opposite sides of quilt center, followed by (1) **C** 3" x 55-1/2" strip to the top and bottom of quilt center.

FINISHING: Layer quilt top, batting and backing together to form quilt sandwich. Baste and quilt as desired. Bind using **B** 2-1/4" strips.



Medley

QUILT DIAGRAM

C 3" x 55-1/2"

