

01.22.2019

Hobo Bag

Designed by LJ Simon
Featuring the Kantha Collection by Whistler Studios
Bag Size Approximately: 16" x 12"

FREE
PROJECT



PLEASE NOTE: BEFORE MAKING YOUR PROJECT, CHECK FOR ANY PATTERN UPDATES AT WINDHAMFABRICS.COM'S FREE PROJECTS SECTION.



Hobo Bag

FABRIC	SKU NUMBER	YARDAGE
	51017-X Multi	1 yard

ADDITIONAL REQUIREMENTS

1 yard: 10/32 or 1/4" cotton piping cord

Special Notes:

**** All seam allowances are 1/4" wide**
Make sure you take your time to cut and sew carefully.

CUTTING

From: 51017-X Multi

- Cut (1) 27 1/2" x 13" rectangle for bag body
- Cut (1) 7 3/4" x 13" rectangle for bag front inset
- Cut (1) 7 3/4" x 11" rectangle for inner pocket
- Cut (2) 3" x WOF (width of fabric) for handles
- Cut (3) 2" strips on bias for corded piping
- Cut (2) bottom sections following template provided

See Cutting Layout

ASSEMBLY

1. Take inner pocket and fold 1/2" toward the wrong side. Press flat. Zigzag stitch at open edge. Diagram 1
2. With wrong sides together, place the pocket on 7 3/4" x 13" bag front inset, matching up bottom and side edges. Pin in place then 1/8" edge stitch down each side to secure.
3. With wrong sides together, seam allowance facing OUT, sew the pocket section to one side of the 27 1/2" x 13" bag body. Repeat for the other side. Press seam allowance flat toward the sides away from pocket. Diagram 3
4. Zigzag stitch on top of seam allowance on outside of bag to hold seam allowance down. See Detail

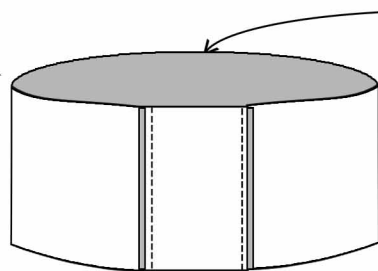
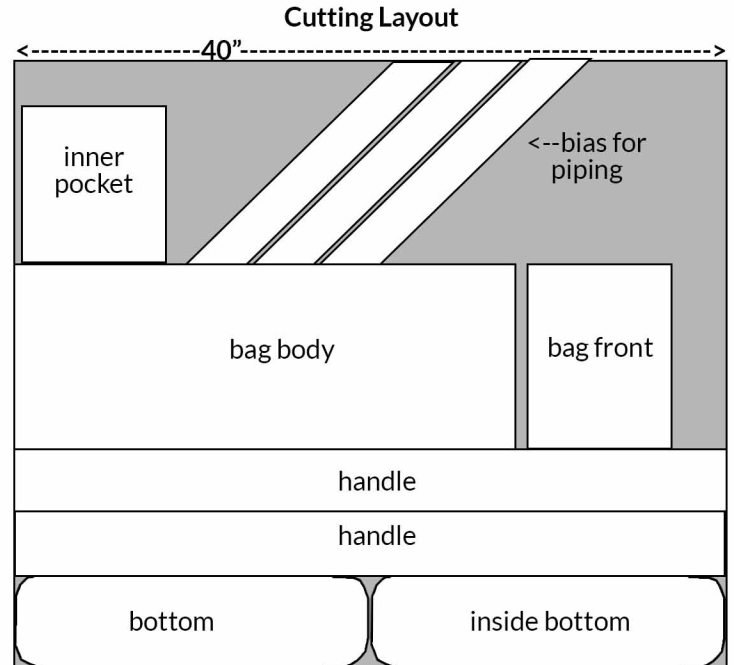
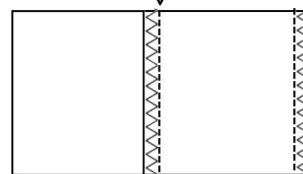

Diagram 3



Detail

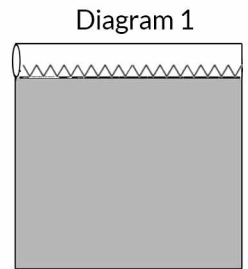

Diagram 1

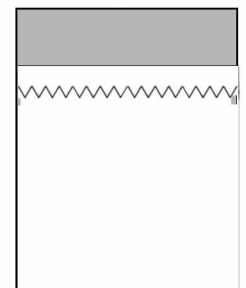

Diagram 2

5. Fold the top edge 1/2" to the wrong side and zigzag topstitch around the top edge as shown in Diagram 1.



Hobo Bag

6. With right sides together, join the short ends of the 2" bias strips perpendicular to each other. Machine stitch a 45 degree diagonal from edge to edge. Diagram 4
Press seam allowance open. Repeat for the 3rd strip adding it to the end.

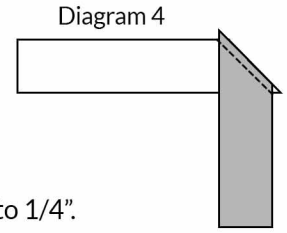

7. With wrong sides together, sandwich the corded piping between the strip and match up edges. Using a zipper foot, sew as close as you can to the piping to make a cover. Trim seam allowance to 1/4". Diagram 5



8. Take the two bottom pieces and with wrong sides together, edge stitch around to hold them together. Diagram 6

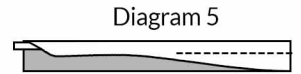

9. With seam allowance facing the edge of bottom piece, pin the piping around the bottom. It is best to then baste in place to be sure it doesn't shift in sewing. Overlap ends on one side by crossing the ends over each other when you have sewn all around. Cut off excess so you have about 1" extension beyond overlap. Carefully cut away the cord inside the piping in the seam allowance to reduce bulk when stitching over the overlap. Diagram 7

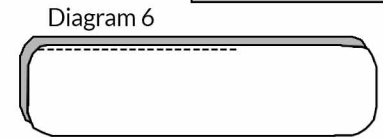

10. With the wrong side facing out, center the pocket inset from side to side on the flat. Put a pin on each bottom and top edge to mark. Take the bottom piece and fold in half lengthwise and mark with a pin.

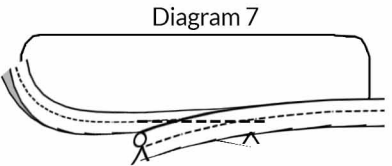

11. Line up the pin at the bottom edge of the bag with the pin on each bottom edge of the bag and carefully put pins around the bottom and baste to secure. Then machine stitch the two sections together. Diagram 9

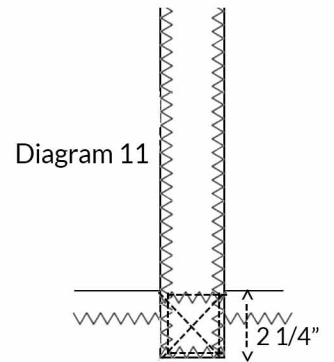
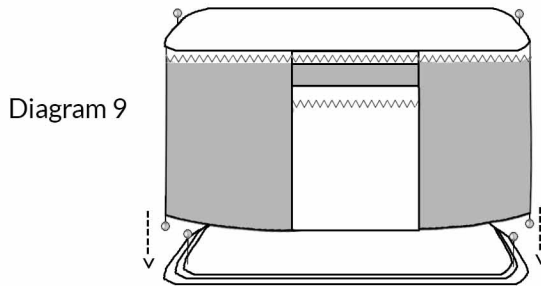

12. Turn bag to the outside. Press to make seams as flat as possible.

13. With right sides together, sew around all sides of the handle strips leaving a 3-4" opening on one long side to turn to the outside. Clip corners and turn to the right side. Slipstitch the opening closed. Zigzag stitch around all sides near the edge. Diagram 10

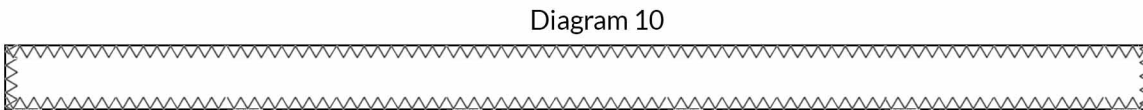

14. On top edge where you placed a pin to mark to the sides of the bag, center the handle strap over that point and extend 2 1/4" below the top edge of the bag. Diagram 11

15. Straight stitch around all sides and stitch an 'X' in the middle to make it more secure. Repeat for the other side.

Your Hobo Bag is now complete and ready to use.



Hobo Bag

BOTTOM TEMPLATE

Template includes 1/4" seam allowance

PRINT AT 100% SCALE

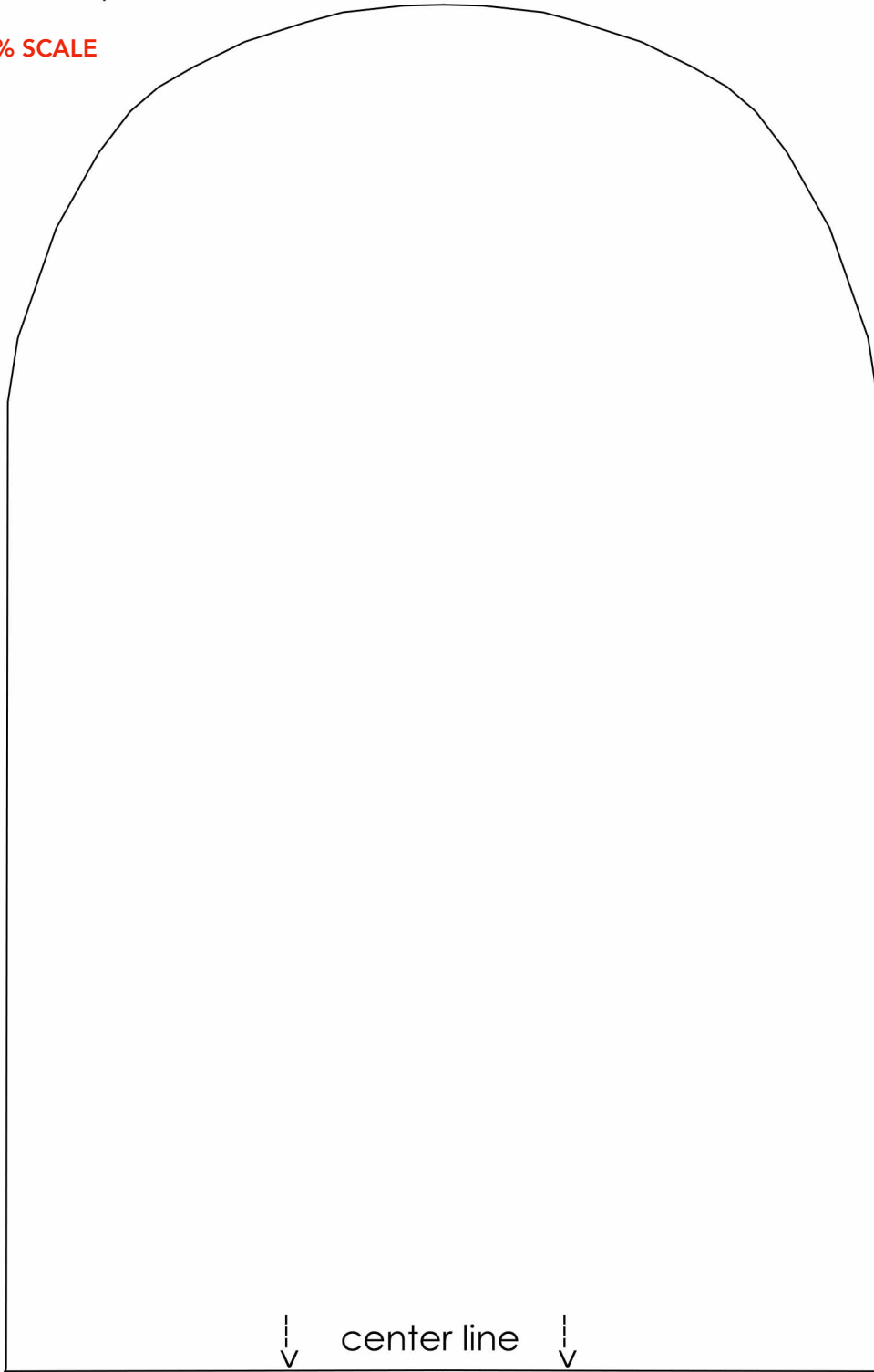

Cut out 2 pieces and join together to make the template the full length

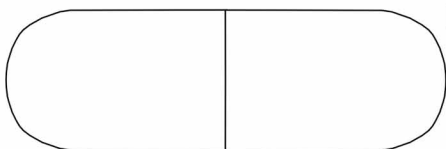

Before following cutting layout

Full length detail