

ADVANCED
SKILL

Cardinal's Bouquet

designed by Marsha Evans Moore
featuring Rowan fabric collection by Whistler Studios
SIZE: 66" x 66"

FREE
PROJECT



THIS IS A DIGITAL REPRESENTATION OF THE QUILT TOP, FABRIC MAY VARY.

PLEASE NOTE: BEFORE MAKING YOUR PROJECT, CHECK FOR ANY PATTERN UPDATES AT WINDHAMFABRICS.COM'S FREE PROJECTS SECTION.



Cardinal's Bouquet





Note: Please read the entire pattern before you begin. For turned under applique techniques, trace templates and cut along the solid outer line. For raw edge applique techniques, trace templates and cut along the inner solid line. The templates are found on pages 7-16. See applique instruction before cutting templates.

KEY	FABRIC	SKU	YD	CUTTING INSTRUCTIONS
A		52933-2 Crimson	5/8	(2) 16-3/4" squares; cut in half diagonally once to make (4) triangles.
B		52934-3 Tan	7/8	(3) 5-3/4" x WOF strips; sew ends together. Subcut (4) 5-3/4" x 29-1/2" strips; trim ends diagonally. (2) 1-5/8" x WOF strips; subcut (2) 1-5/8" x 19-1/4" strips and (2) 1-5/8" x 17" strips. (1) 4-3/8" x WOF strip; subcut (6) 4-3/8" squares. Cut squares in half diagonally twice to make (24) triangles.
C		52935-2 Crimson	1/3	(2) Large Tulip templates. (2) Cardinal Wing templates and (2) Cardinal Wing templates reversed. (16) Small Flower templates. (3) Large Flower Center templates.
D		52935-2 Cocoa	1-3/4	(7) 2" x WOF strips; sew ends together. Subcut (2) 2" x 66-1/2" strips and (2) 2" x 63-1/2" strips. (5) 1-7/8" x WOF strips; sew ends together. (2) 1-7/8" x 47-1/4" strips, and (2) 1-7/8" x 44-1/2" strips. (2) 4-3/8" x WOF strips; Subcut (15) 4-3/8" squares and (2) 4-1/4" squares. (2) 4-1/4" x WOF strips; Subcut (18) 4-1/4" squares. Cut all 4-3/8" and 4-1/4" squares in half diagonally twice for a total of (60) 4-3/8" triangles and (80) 4-1/4" triangles. (1) Urn template. (3) Large Center Templates. (28) Small Center templates.

Project Disclaimer: Every effort has been made to ensure that all projects are error free. All the information is presented in good faith, however, no warranty can be given nor results guaranteed. Therefore, we assume no responsibility nor damages that may occur when referring to this pattern. When errors are brought to our attention, we make every effort to correct and post a revision as soon as possible. We suggest you check windhamfabrics.com for pattern updates and to test the pattern prior to making the project. Test templates first, before cutting all the pieces. Free projects are not for resale.

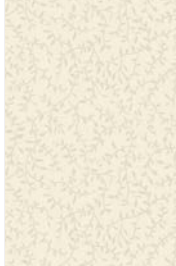

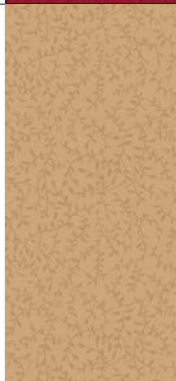
Cardinal's Bouquet

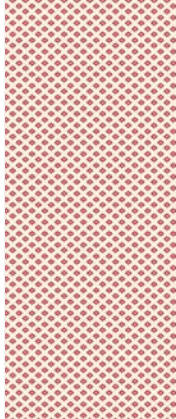
KEY	FABRIC	SKU	YD	CUTTING INSTRUCTIONS
E		52936-1 Ivory	2	(1) 17" square. (2) 11-3/4" squares; cut squares in half diagonally once to make (4) triangles. (6) 5-1/2" x WOF strips; sew ends together. Subcut (2) 5-1/2" x 60-1/2" strips, (2) 5-1/2" x 50-1/2" strips.
F		52936-2 Crimson	7/8	FOR BINDING: (7) 2-1/4" x WOF strips, sew short ends together. (3) Large Flower templates. (12) Small Flower templates. (2) Cardinal templates and (2) Cardinal templates reversed.
G		52936-3 Tan	3/4	For raw edge appliqué (from templates): (1) 3/8" x 6-1/2" stem, (2) 3/8" x 4-3/4" stems, (1) Curved stem, (1) Curved stem reversed, (2) branches, (2) branches reversed, (12) border stems, (12) border stems reversed and (4) corner stems. For turned under appliqué: (13) 1-1/4" x 30" bias strips and (3) 1-1/4" x 18" bias strips.
H		52937-1 Ivory	1/4	(2) 2" x WOF strips; subcut (4) 2" x 19-1/2" strips. Trim ends diagonally.
I		52937-3 Tan	3/8	(4) 2" x WOF strips; subcut (4) 2" x 32-1/2" strips. Trim ends diagonally.
J		52938-1 Ivory	1-1/8	(3) 4-1/4" x WOF strips; subcut (19) 4-1/4" squares, (4) 2-3/8" squares and (4) 2" squares. Cut (4) 4-1/4" and 2-3/8" squares diagonally once to make (8) HST triangles each. Cut remaining 4-1/4" squares diagonally twice to make (76) QST triangles. (3) 4-3/8" x WOF strip; subcut (24) 4-3/8" squares. Cut squares in half diagonally twice to make (96) triangles. Cut (1) heart template.



Cardinal's Bouquet

KEY	FABRIC	SKU	YD	CUTTING INSTRUCTIONS
K		37098-37 Olive	1/2	(2) Calyx templates. (6) Large Leaf templates. (104) Medium Leaf templates. (8) Small Leaf templates.
		Backing	4-1/2	Batting 74" x 74"

ADDITIONAL MATERIALS

Thread to match fabrics

Sewing machine

Template plastic

Basic sewing supplies

Rotary cutter, ruler and mat

Optional: For turned under edge appliqué: freezer paper or other template paper.

For raw edge appliqué: paper backed fusible webbing.

CENTER BLOCK

1. Using your favorite appliqué method, prepare the appliqué pieces. Prepare raw edge appliqué stems in the same way as other pieces.

2. For turned edge appliqué stems, fold (1) **G** strip in half lengthwise with wrong sides together. Sew 3/8" from fold. Sew remaining strips in half lengthwise with wrong sides together and sew 1/4" from fold. Trim raw edge 1/8" from stitching. Cut the bias strips into the lengths indicated. Press stem flat with seam centered on one side. Make the number indicated.

3. Mark the vertical and horizontal center of (1) **E** 17" square. Align the broken lines on the Center Pattern to the drawn lines on the block and trace to the left side of the block. Reverse the Center Pattern and trace to the right side of the block.

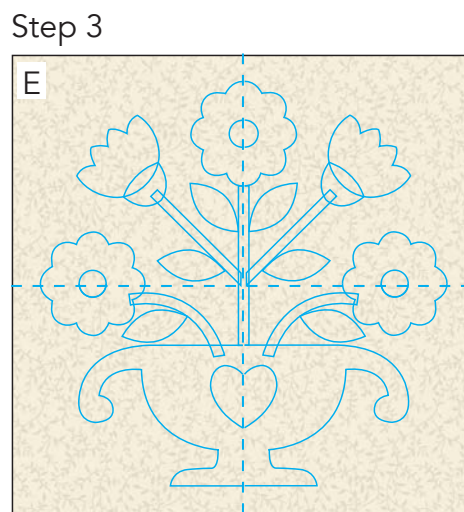
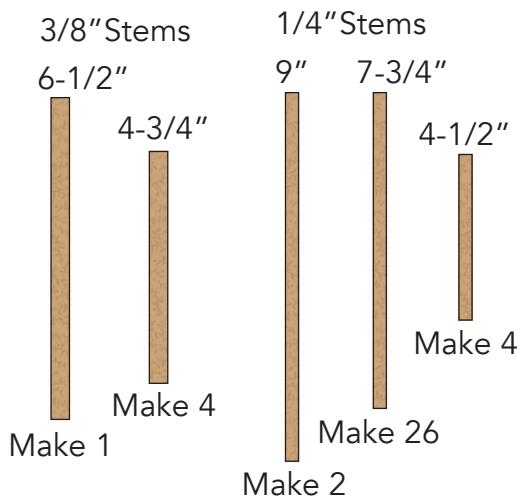
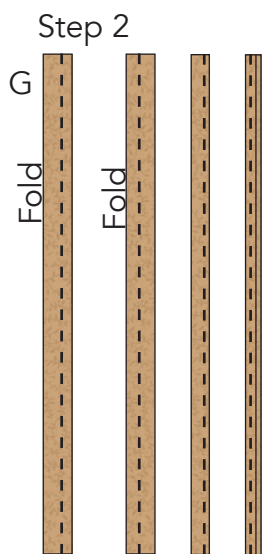



Cardinal's Bouquet

4. Fuse, baste or pin the 3/8" wide **G** stems in place. Trim ends so stems overlap adjacent shapes 1/4". Tuck the ends of the diagonal stems under the edge of the center stem. Sew along the edge of the stems.
5. Fuse, baste or pin (1) **D** Urn, (3) **F** Large Flower appliqués, (2) **C** Tulip appliqués and (6) **K** Large Leaf appliqués in place. Sew along the edge of the pieces.
6. Fuse (2) **K** Calyx appliqués, (3) **D** Large Center appliqués and (1) **J** Heart appliqué in place. Sew along the edge of the pieces. Make 1.

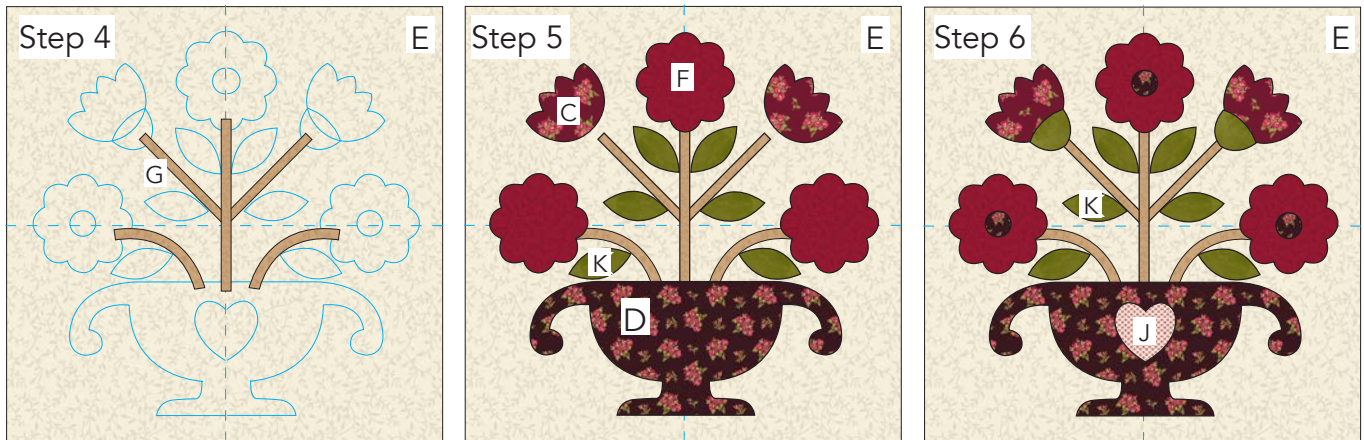

CARDINAL TRIANGLES

7. Trace Upper Cardinal Pattern to (1) **E** triangle placing the dashed lines along the 1/4" seamline. Reverse the Upper Cardinal Pattern and trace to (1) **E** triangle in the same manner.
8. Repeat step 7 for the Lower Cardinal Pattern.
9. Fuse, baste or pin the 1/4" wide **G** stems in place, using 9" lengths for the lower triangle birds and 7-3/4" lengths for the upper triangle birds. Trim ends so stems overlap seam allowance. Sew along the edge of the stems.
10. Fuse, baste or pin (1) **F** Cardinal appliqués and (2) **K** Medium Leaf appliqués in place. Sew along the edge of the pieces.
11. Fuse, baste or pin (1) **C** Wing appliqués in place. Sew along the edge of the pieces. Embroider the eye using black thread. Make 1 each.

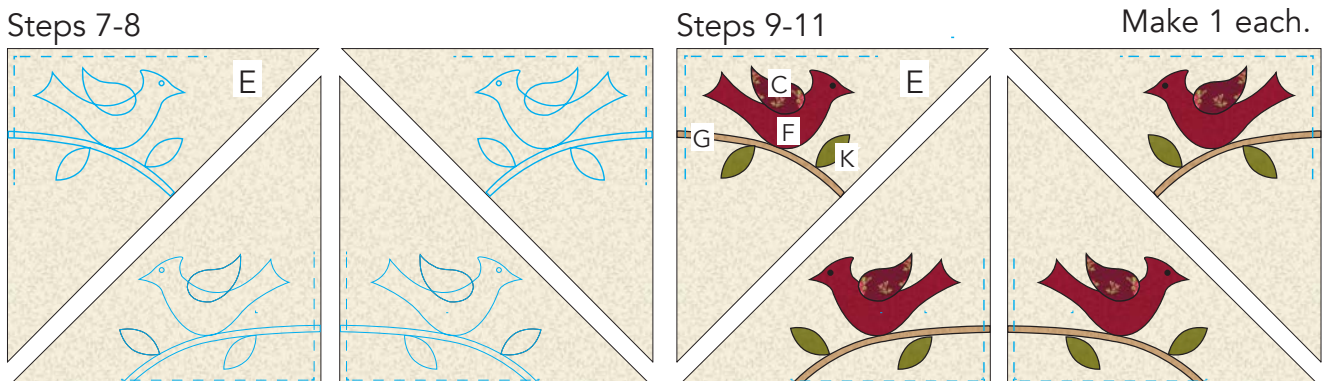



Cardinal's Bouquet

QUILT CENTER

12. Sew (6) **B** 4-3/8" triangles and (5) **J** 4-3/8" triangles together along the short edges to make a triangle strip. Unfinished strips should measure approximately 2-1/8" tall x 20" along seamline of long edge. Make 4.

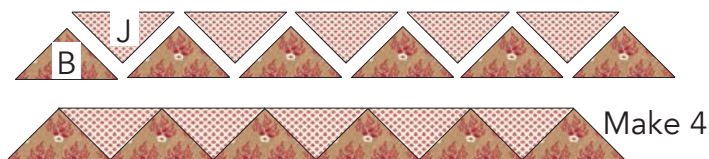

13. Sew (1) **B** 1-5/8" x 17" strip to each side of center block. Sew (1) **B** 1-5/8" x 19-1/4" strip to top and bottom of center block.

14. Sew (1) **B/J** triangle strip to each side of **B** strip. Sew (1) **J** 4" HST triangle to each corner. Make 1.

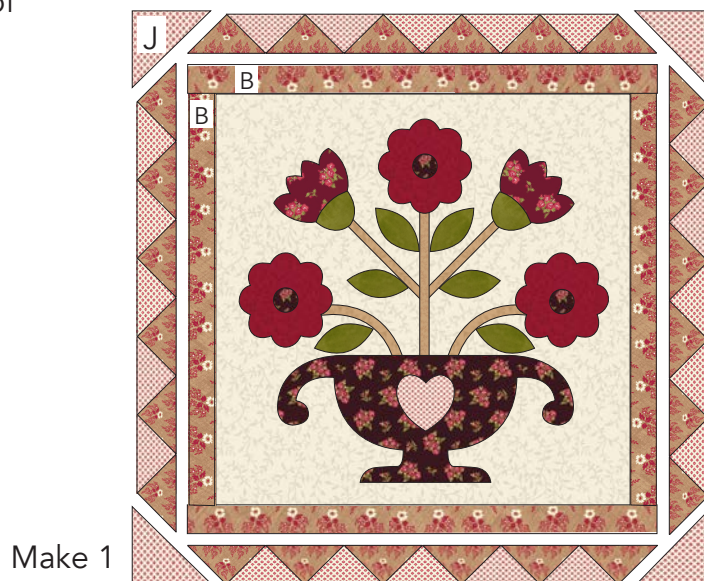

15. Following the layout diagram on page 8, sew (1) **A** 16-3/4" triangle to each side of the center matching the middle of each side of the quilt center with the middle of each long edge of the triangle.

16. Sew (1) **I** 2" x 32-1/2" strip to each diagonal side of quilt.

17. Sew (1) **B** 5-3/4" x 29-1/2" strip to each diagonal side of quilt.

18. Sew (1) **H** 2" x 19-1/2" strip to each diagonal side of quilt.

19. Sew (1) Cardinal Triangle to each corner of quilt to make a square quilt center, noting the orientation of birds and branches. Quilt center should measure 44-1/2" square; trim as needed.

TRIANGLE BORDERS

20. Sew (15) **D** 4-3/8" triangles and (14) **J** 4-3/8" QST triangles together along the short edges to make (1) short triangle border strip. Unfinished strips should measure approximately 2-1/8" tall x 48-1/8" along long edge. Make 4.



21. Sew (20) **D** 4-1/4" triangles and (19) **J** 4-1/4" QST triangles together. Sew (2) **J** 2-3/8" triangle to ends to make (1) long triangle border strip. Make 4.





Cardinal's Bouquet

APPLIQUÉ BORDERS

22. Draw a line 1/4" from the ends of (2) **E** 5-1/2" x 50-1/2" strips. Draw 2 lines 16-1/2" in from the two lines. Center section should also measure 16-1/2". Trace the border placement centered on the sections of the strips to make the side borders. Make 2.

23. Draw a line 1/4" from the ends of (2) **E** 5-1/2" x 60-1/2" strips. Draw 2 lines 5-1/4" in from the two lines. Draw 2 lines 16-1/2" in from the second lines. Center section should also measure 16-1/2". Trace the border placement centered on the 16-1/2" sections of the strips and the corner placement on the 5-1/4" sections to make the top and bottom borders. Make 2.

Step 22

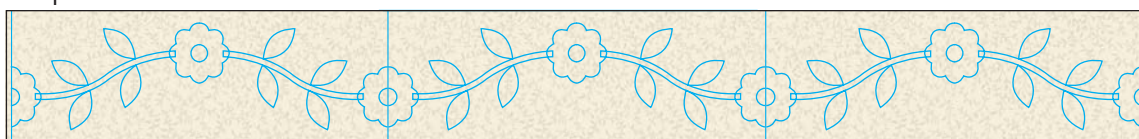

Make 2

Step 23

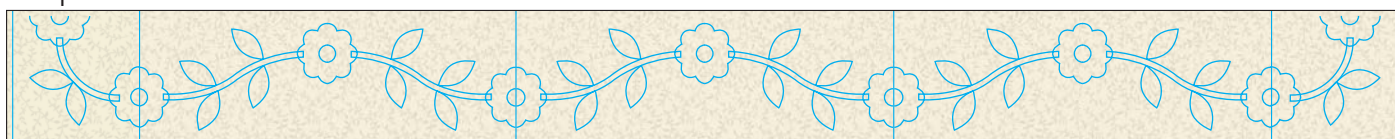

Make 2

24. Fuse, baste or pin the 1/4" wide **G** stems in place. Trim ends so stems overlap adjacent drawn shapes 1/4" if needed. Sew along the edge of the stems.

25. Fuse, baste or pin the **C** and **F** small flower appliqués, **K** medium leaf appliqués and **K** small leaf appliqués in place. Omit the flower that overlaps the seam of the borders. Sew along the edge of the pieces.

26. Fuse, baste or pin the **D** Center appliqués centered on small flowers. Sew along the edge of the pieces. Make 2 each.

Steps 24-26

Side Border

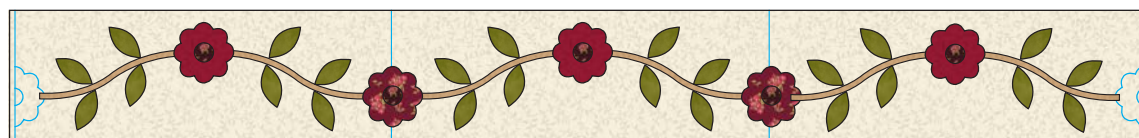

Make 2

Top and Bottom Border

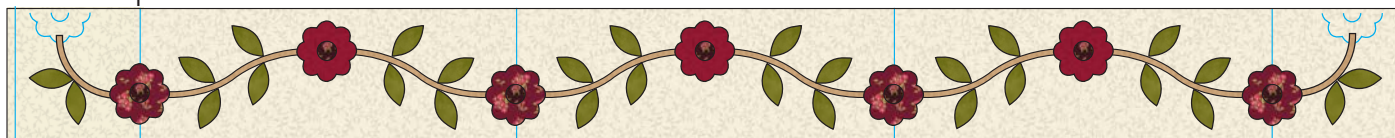

Make 2



Cardinal's Bouquet

QUILT ASSEMBLY

27. Following the Quilt Layout, sew (1) **D** 1-7/8" x 44-1/2" strip to each side of quilt center. Sew (1) **D** 1-7/8" x 47-1/4" strip to top and bottom of quilt.

28. Sew (1) short **D/J** triangle border to each side of quilt. Sew (1) **J** 4" HST triangle to corners. Note orientation of triangles.

29. Sew (1) 5-1/2" x 50-1/2" appliqué border to each side of quilt noting the orientation of the small flowers. Sew (1) 5-1/2" x 60-1/2" appliqué border to top and bottom of quilt.

30. Pin, baste or fuse (4) **C** small flower appliqué to position over seam of borders. Sew along the edge of the flowers.



31. Sew (1) **D/J** long triangle border to each side of quilt center. Sew (2) **J** 2" squares to ends of (2) **D/J** long triangle borders. Sew to top and bottom of quilt. Note orientation of triangles.

32. Sew (1) **D** 2" x 63-1/2" strip to each side of quilt center. Sew (1) **D** 2" x 66-1/2" strip to top and bottom of quilt.

Templates

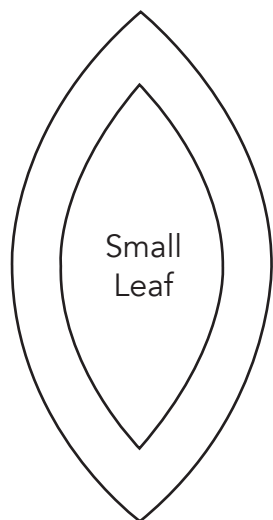

Small Leaf

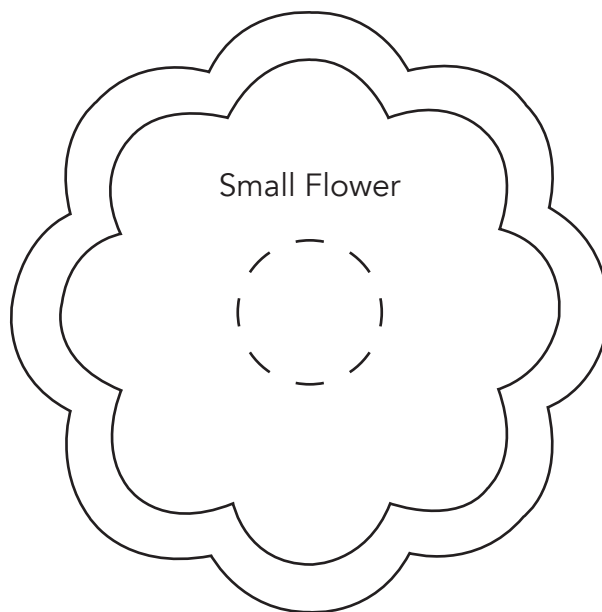

Small Flower

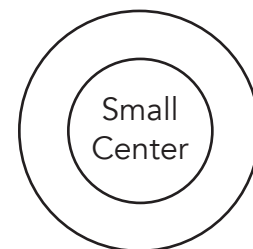

Small Center



Cardinal's Bouquet

Quilt Layout



FINISHING: Layer quilt top, batting and backing together to form quilt sandwich. Baste and quilt as desired. Bind using **F** 2-1/4" strips.



Cardinal's Bouquet

Center Pattern
Top

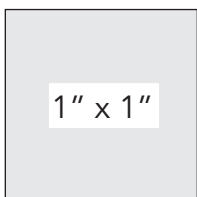
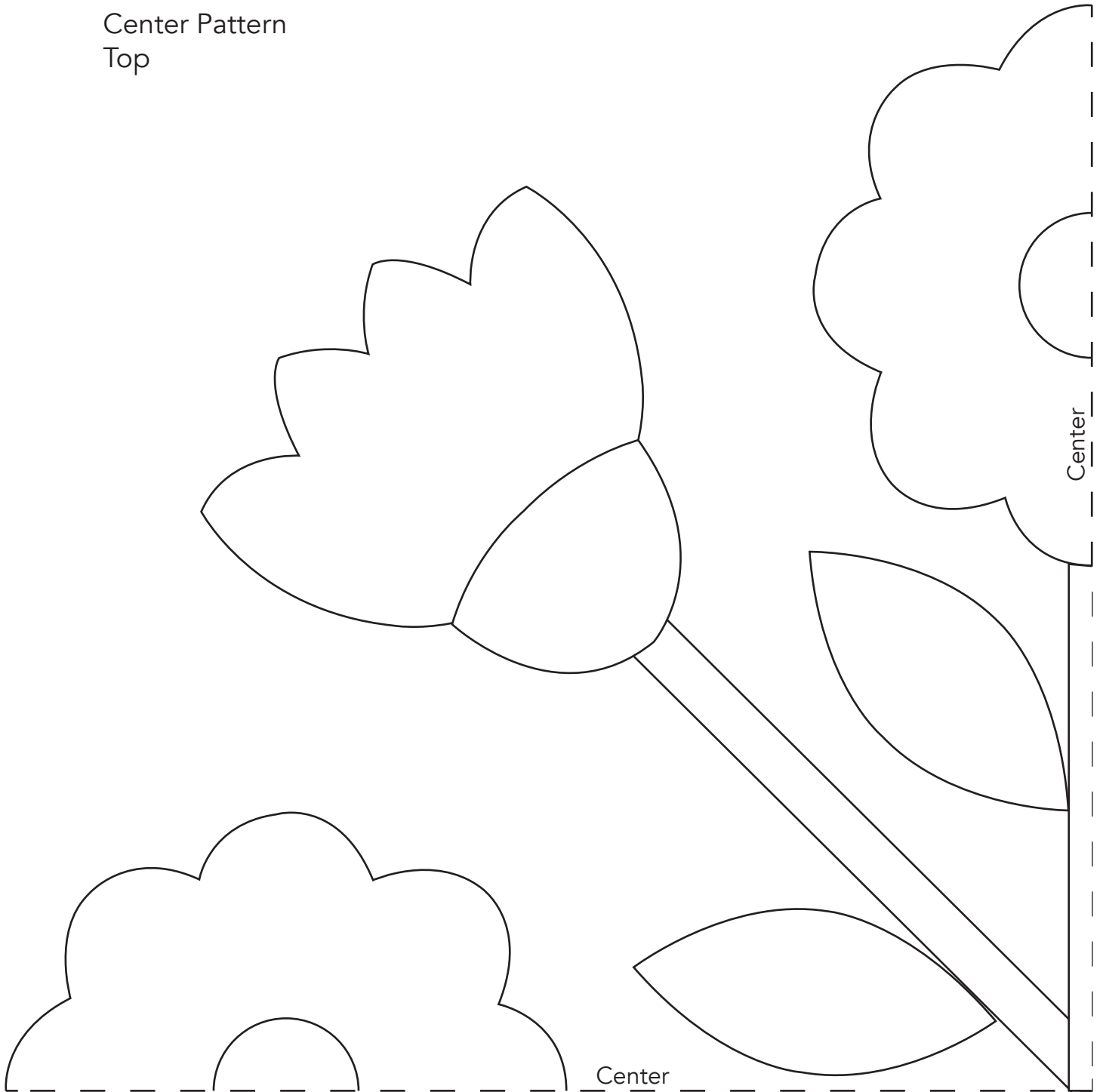

Print at 100%.



Cardinal's Bouquet

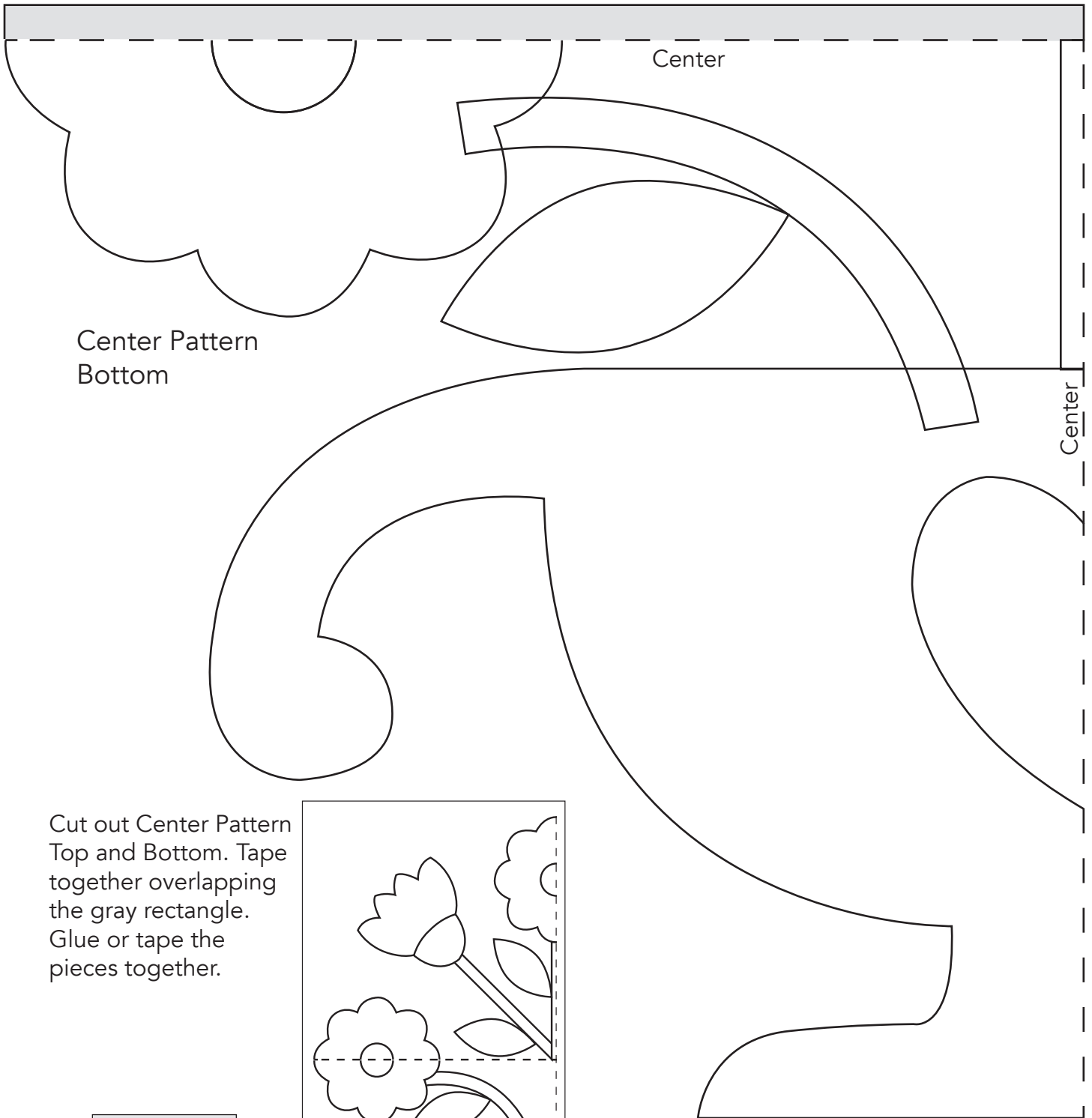

Center Pattern
Bottom

Cut out Center Pattern
Top and Bottom. Tape
together overlapping
the gray rectangle.
Glue or tape the
pieces together.

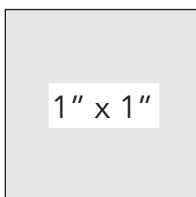

1" x 1"

Print at 100%.

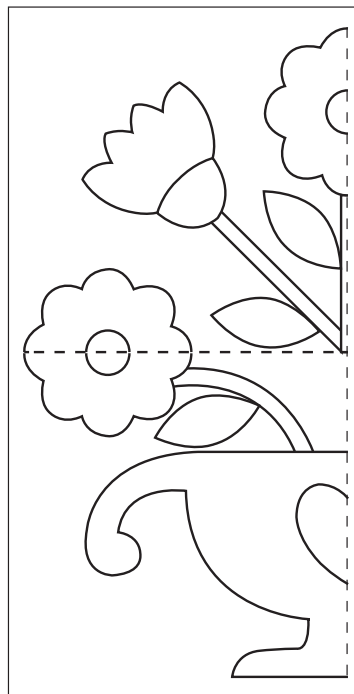



Cardinal's Bouquet

Templates

Trace outer lines for turned edge appliqué.

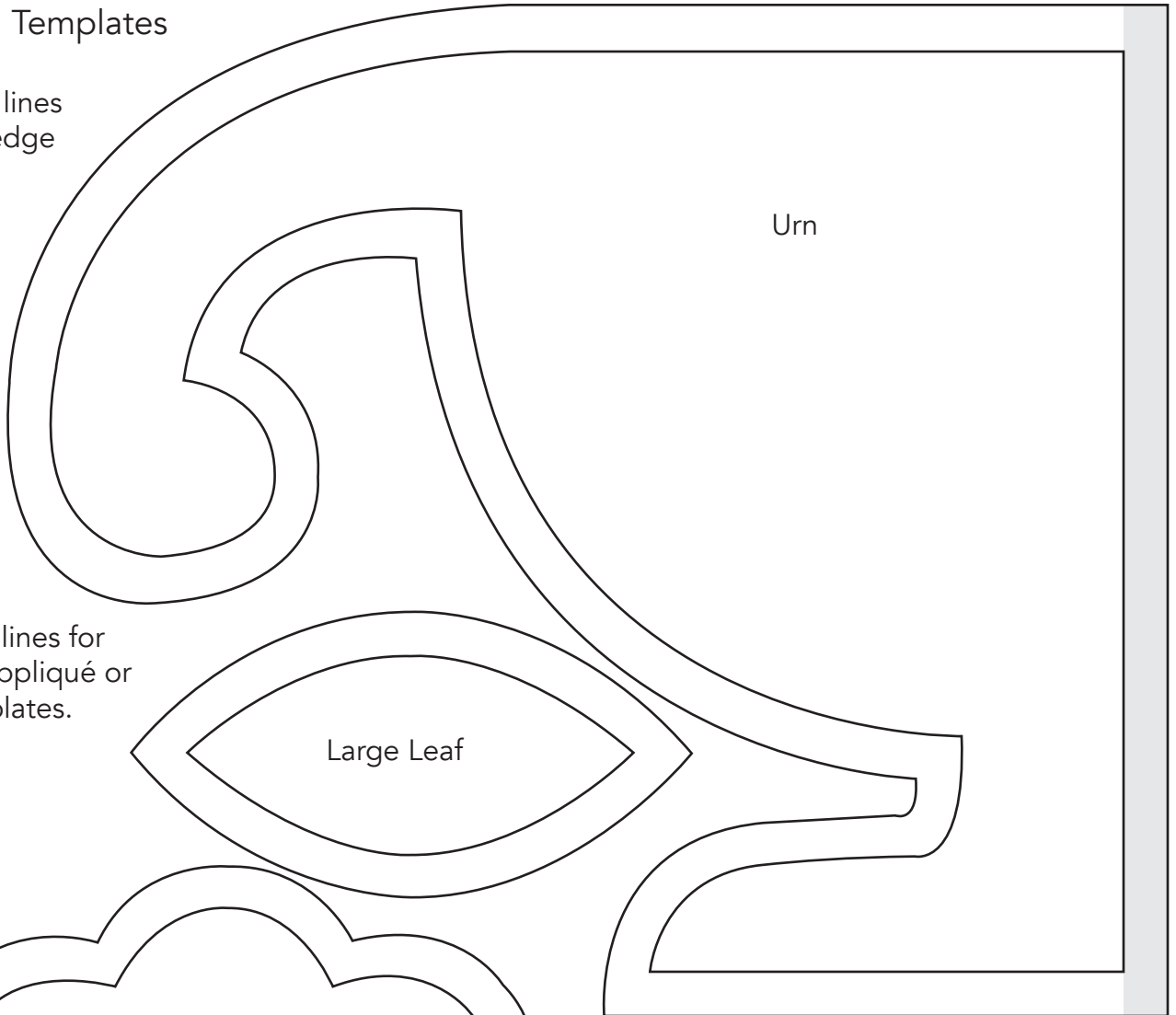

Urn

Trace inner lines for raw edge appliqué or paper templates.

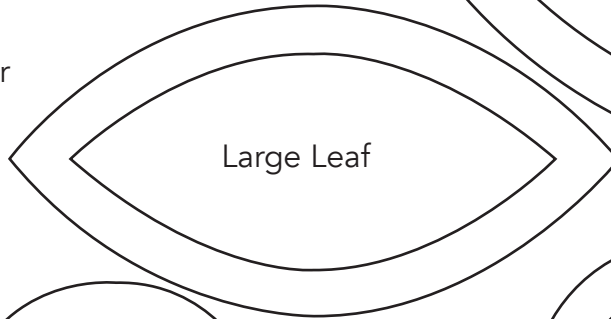

Large Leaf

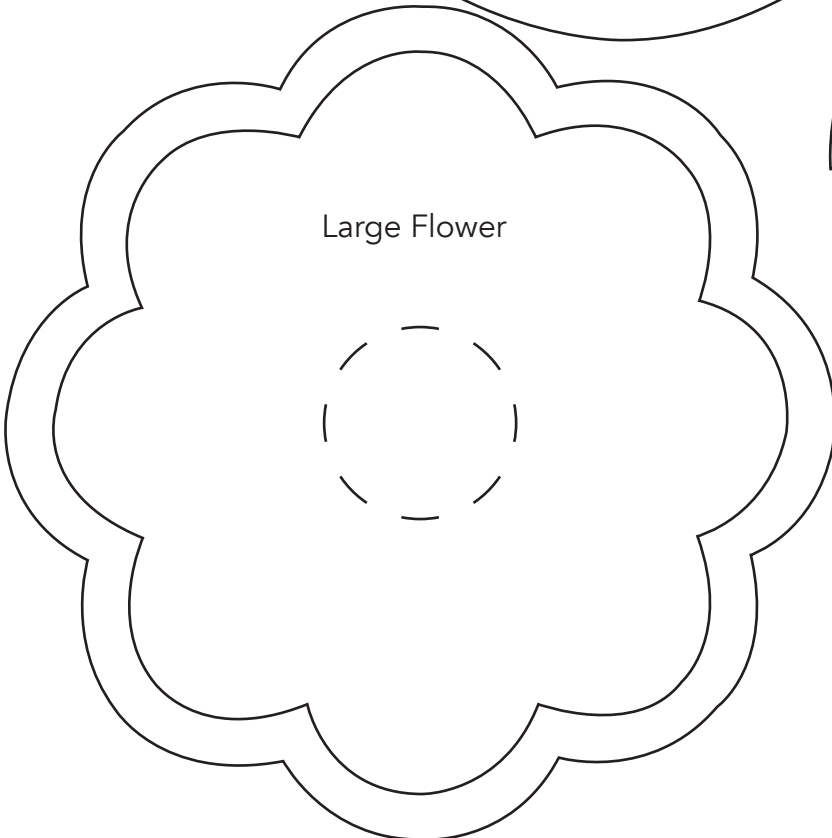

Large Flower

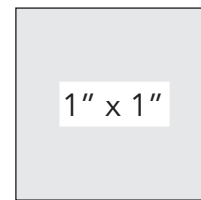

1" x 1"

Print at 100%.

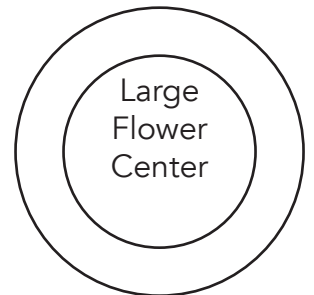

Large Flower Center

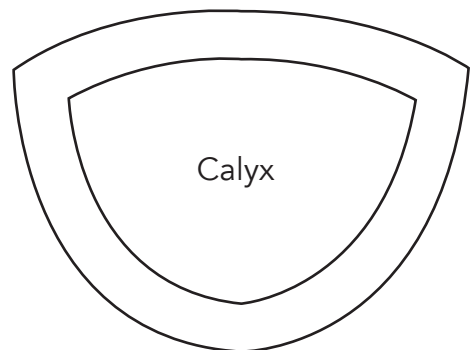

Calyx



Cardinal's Bouquet

Templates

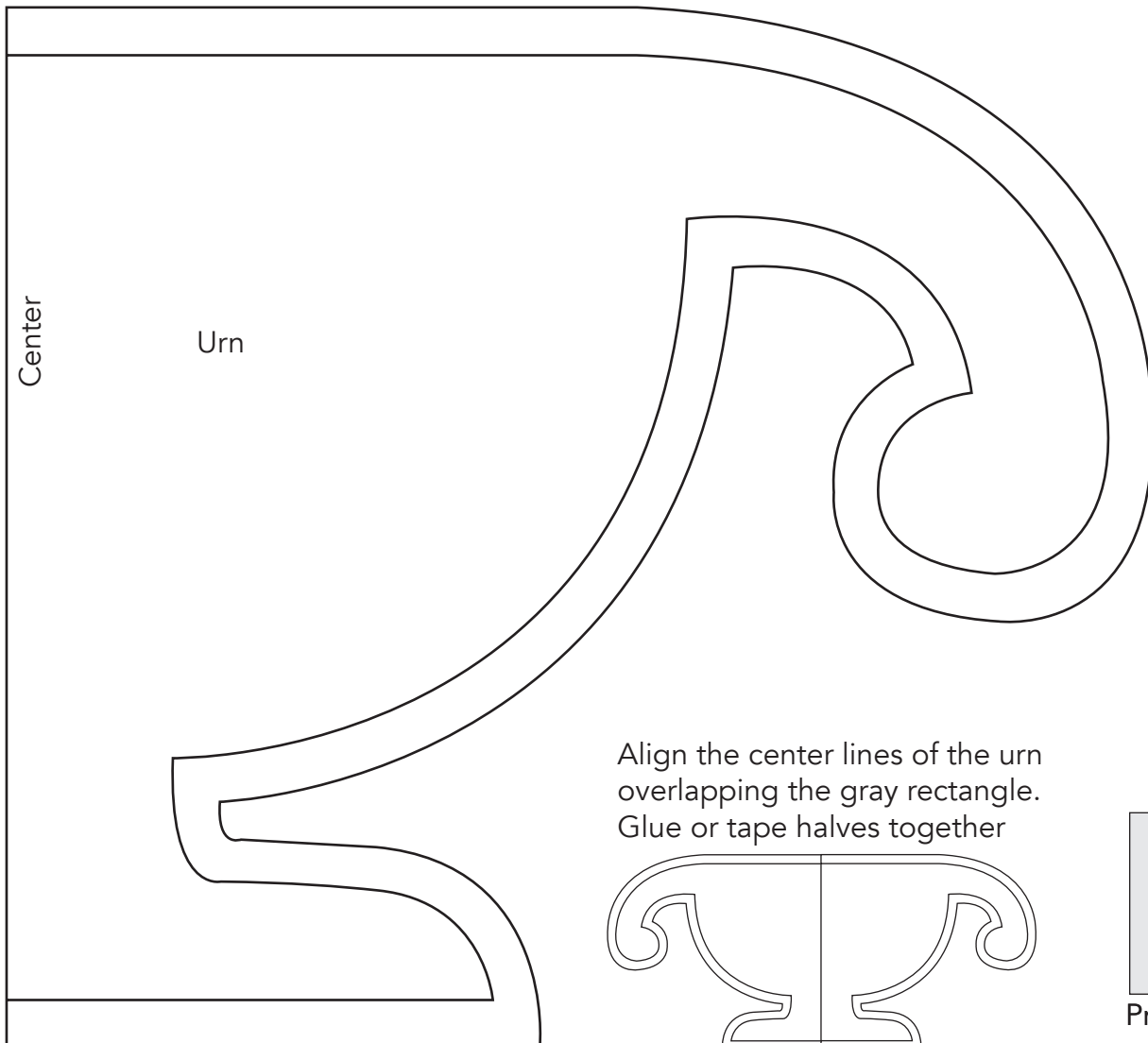
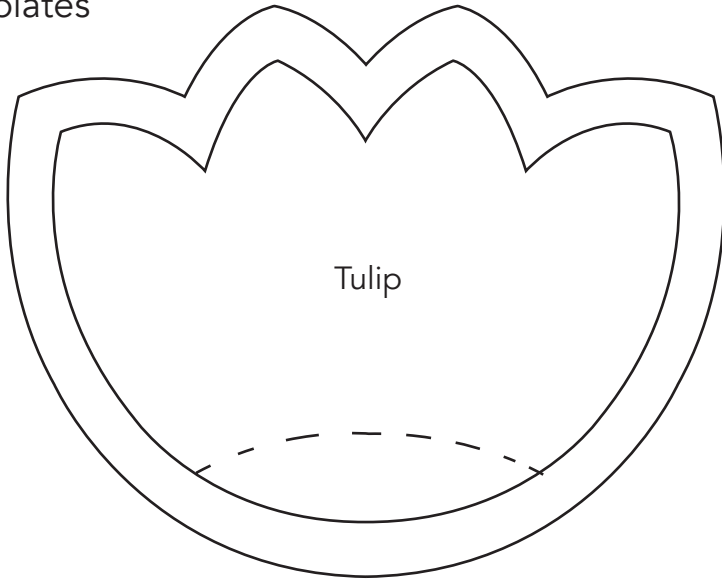
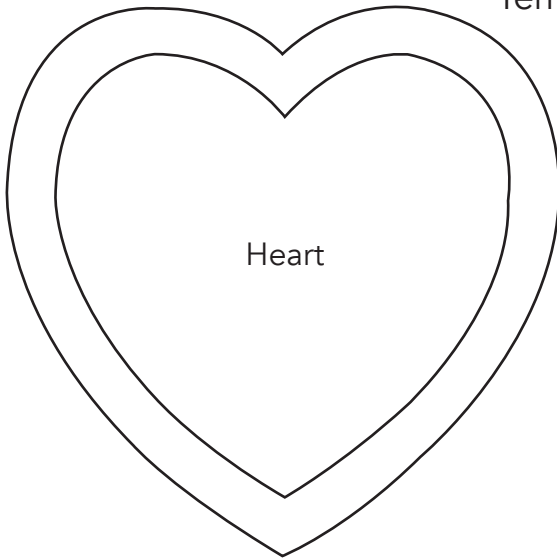

Align the center lines of the urn overlapping the gray rectangle. Glue or tape halves together

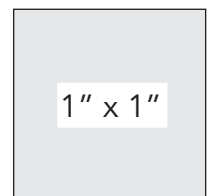
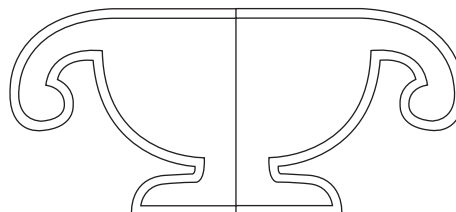

1" x 1"

Print at 100%.



Cardinal's Bouquet

Lower Cardinal
Pattern

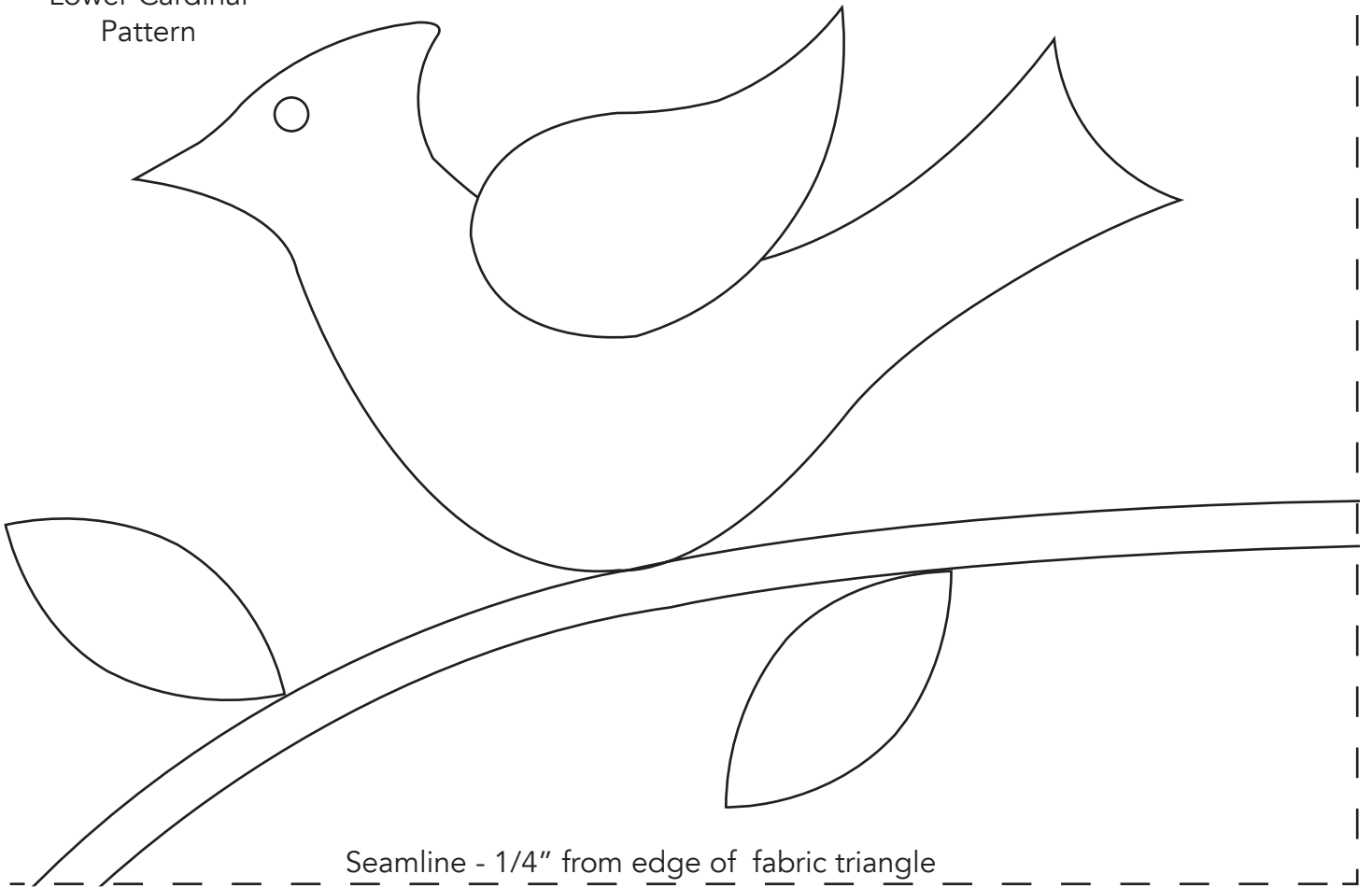

Seamline - 1/4" from edge of fabric triangle

Templates

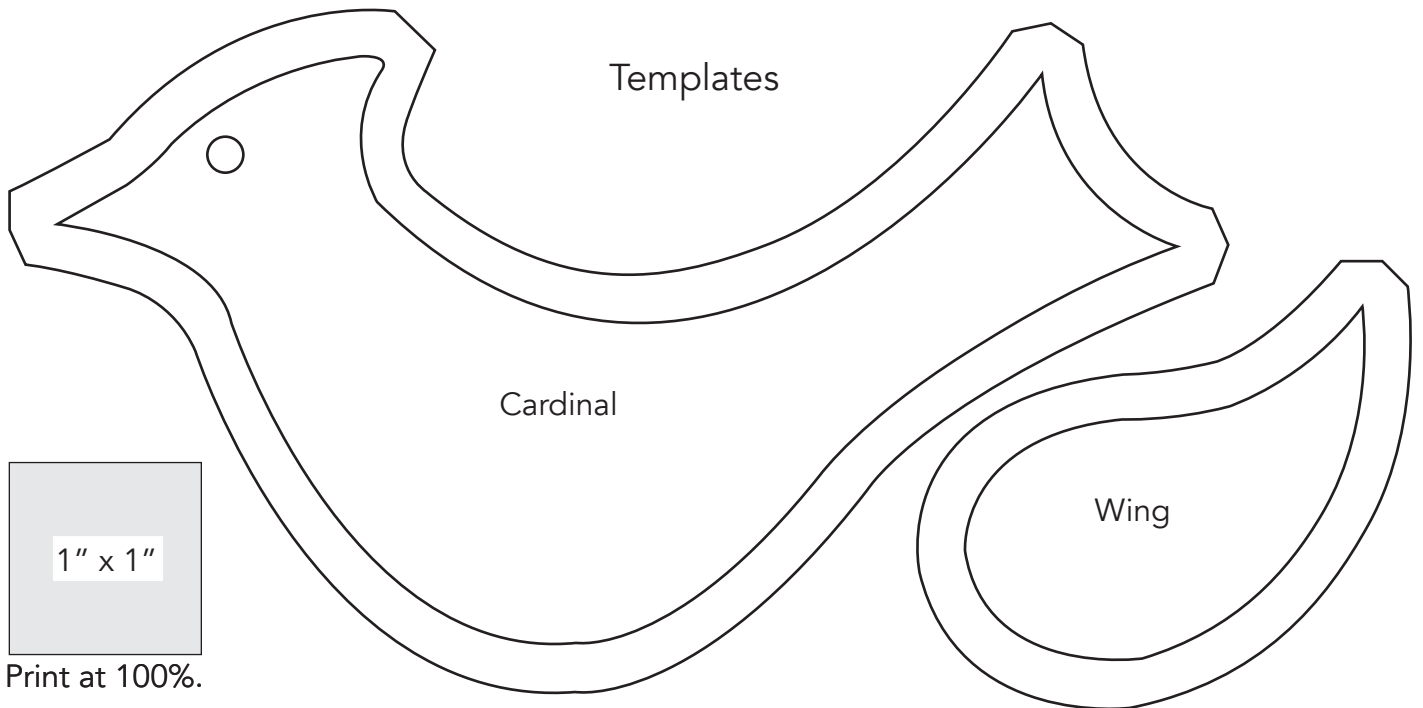

Cardinal

Wing

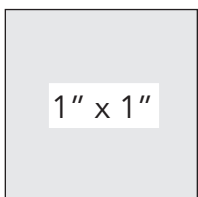

1" x 1"

Print at 100%.



Cardinal's Bouquet

Seamline - 1/4" from edge of fabric triangle

Upper Cardinal
Pattern

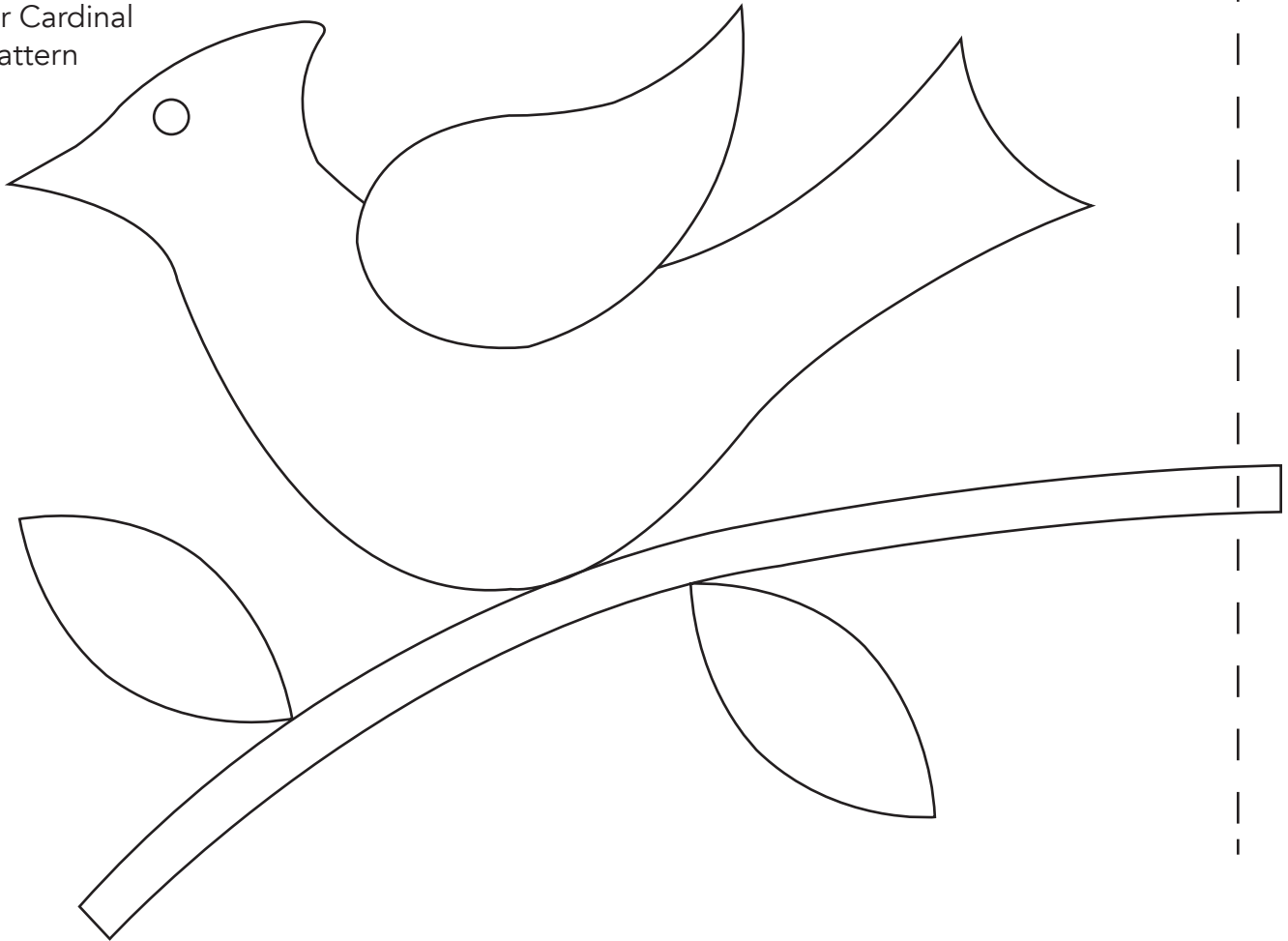

Templates

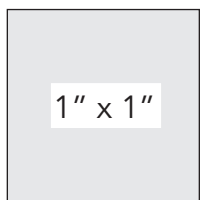

Print at 100%.

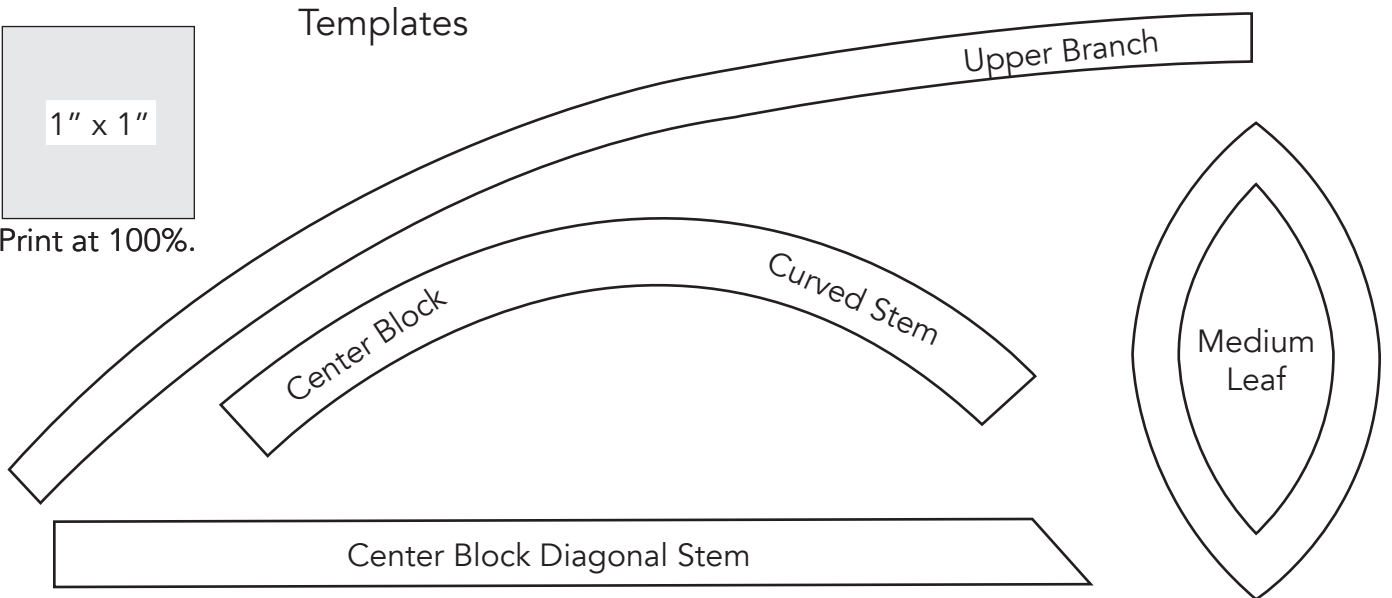



Cardinal's Bouquet

Border Pattern

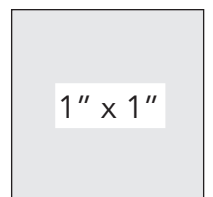
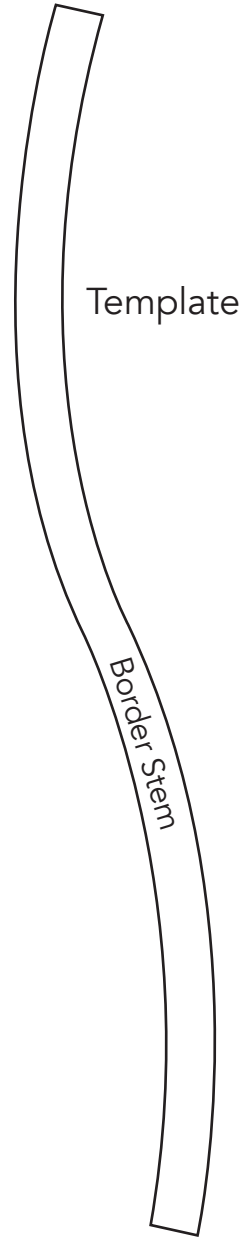
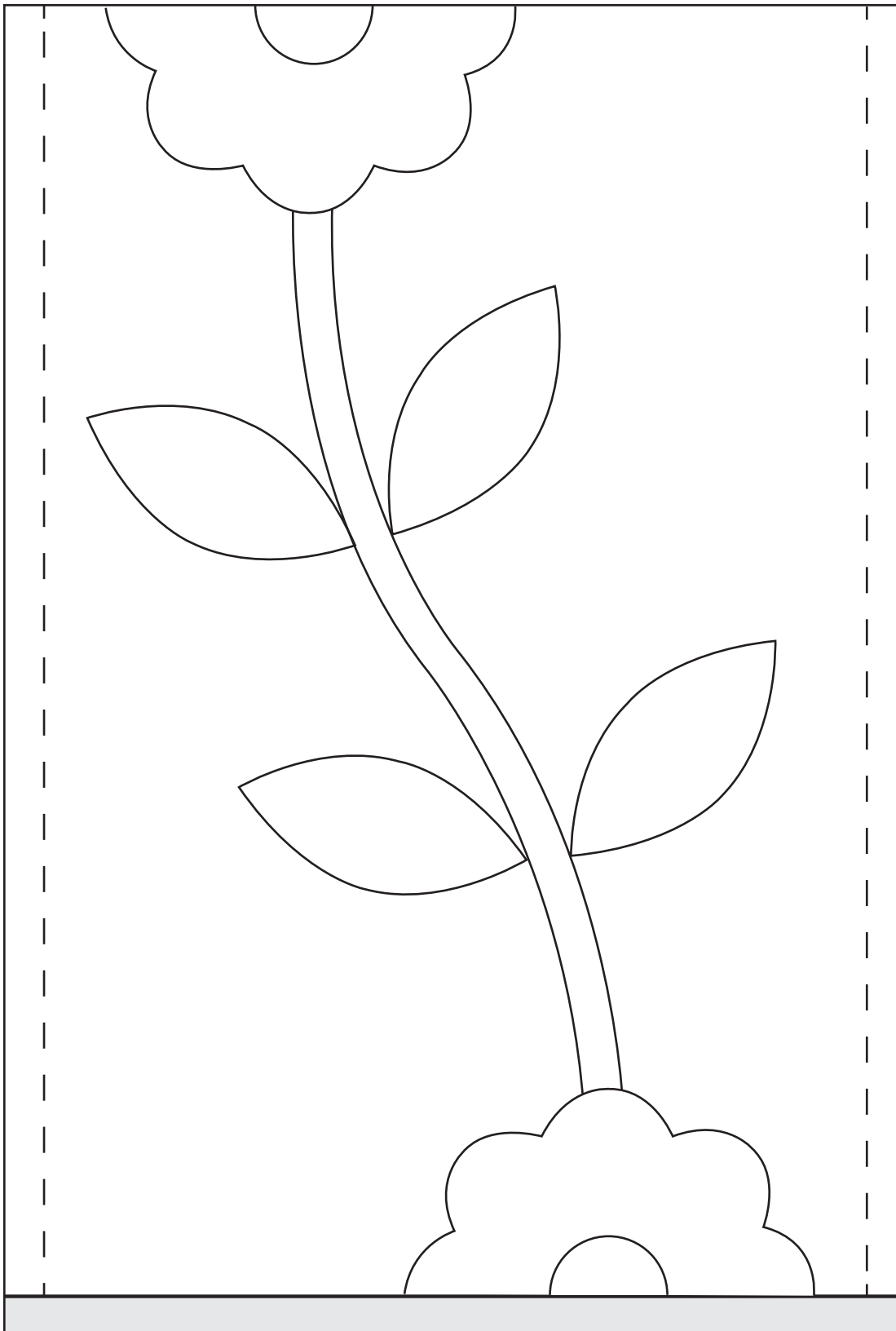

1" x 1"

Print at 100%.



Cardinal's Bouquet

Border Pattern

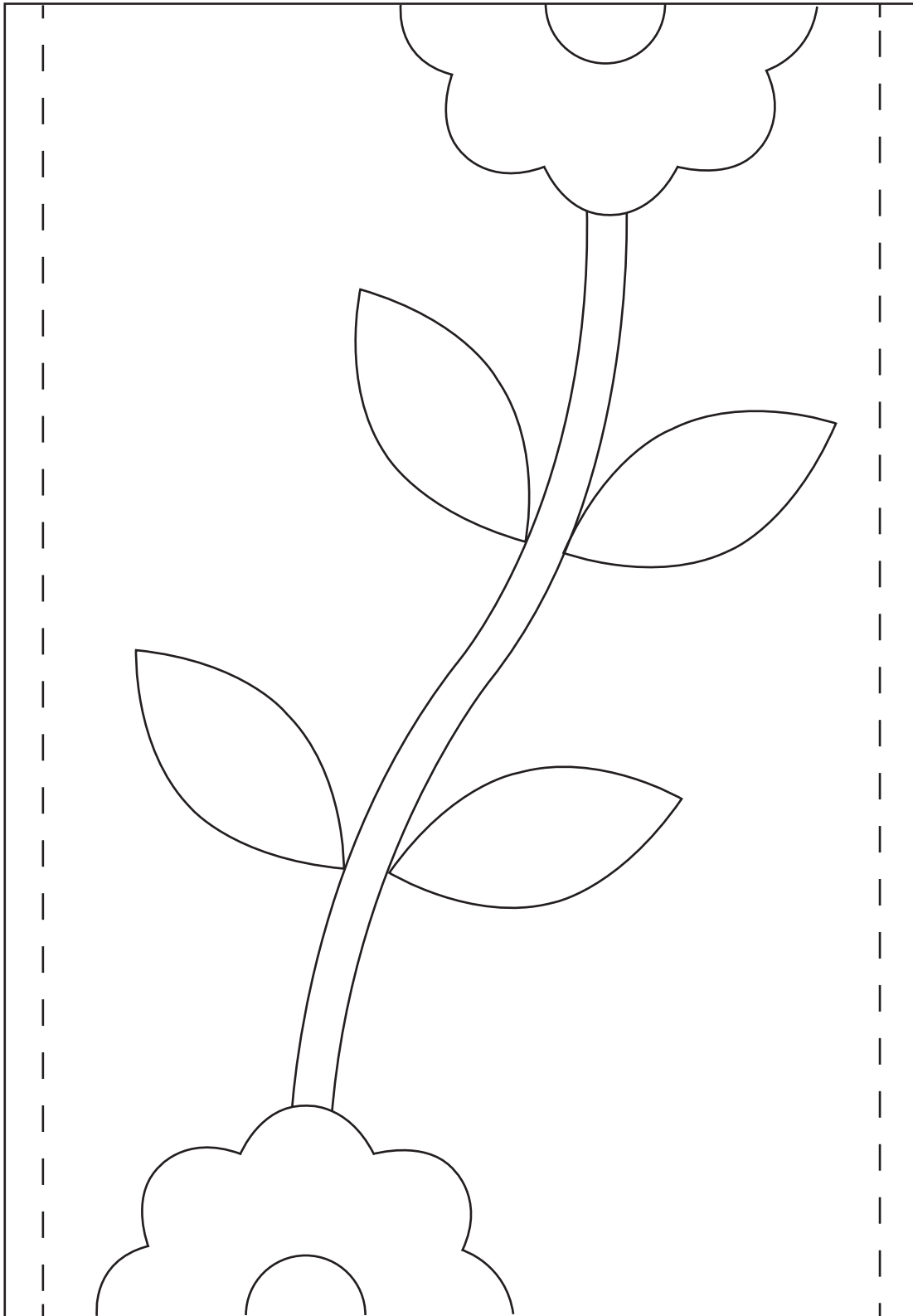

Lower Branch

Template

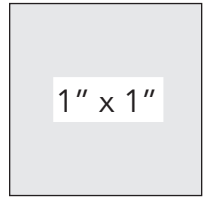

Print at 100%.