

INTERMEDIATE
SKILL

Prismetallic

Designed by Wendy Sheppard
featuring *Sparkle* by Whistler Studios

SIZE: 65" x 75"

FREE
PROJECT

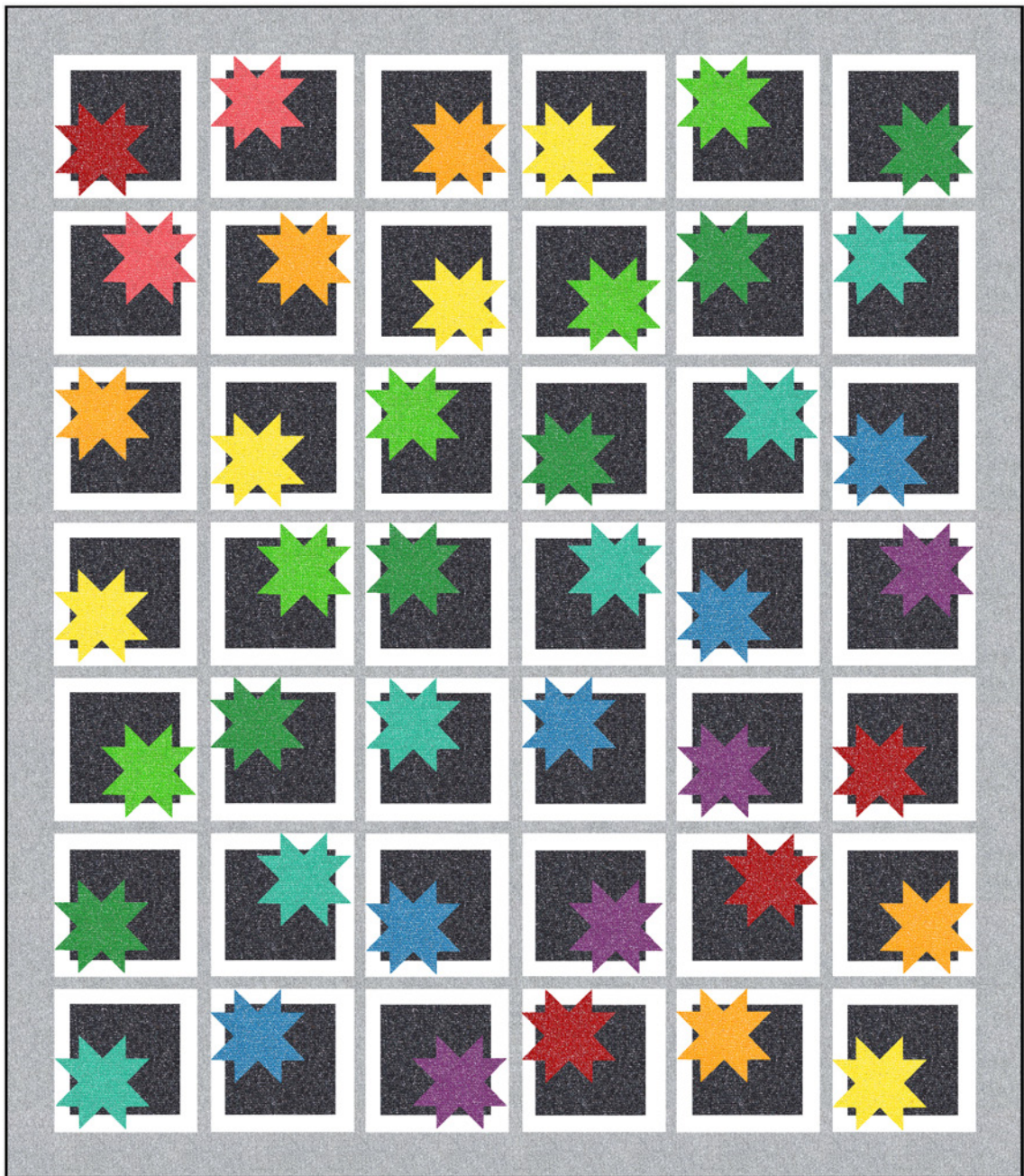

THIS IS A DIGITAL REPRESENTATION OF THE QUILT TOP, FABRIC MAY VARY.

PLEASE NOTE: BEFORE MAKING YOUR PROJECT, CHECK FOR ANY PATTERN UPDATES AT WINDHAMFABRICS.COM'S FREE PROJECTS SECTION.





Prismetallic

PROJECT DISCLAIMER: Every effort has been made to ensure that all projects are error free. All the information is presented in good faith, however, no warranty can be given nor results guaranteed. Therefore, we assume no responsibility nor damages that may occur when referring to this pattern. When errors are brought to our attention, we make every effort to correct and post a revision as soon as possible. We suggest you check windhamfabrics.com for pattern updates and to test the pattern prior to making the project. Test templates first, before cutting all the pieces. Free projects are not for resale.

NOTE: Mark and store your cutting pieces according to size to ease piecing.

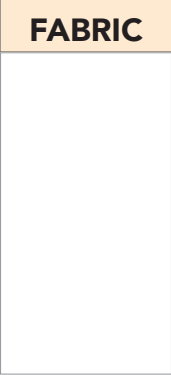





WOF = WIDTH OF FABRIC

KEY	FABRIC	SKU	YD	CUTTING INSTRUCTIONS
A		318355S White	2-1/8	<p>PIECED BLOCKS (28) 1-1/2" x WOF strips; subcut (42) 1-1/2" x 9-1/2", (42) 1-1/2" x 8-1/2", (84) 1-1/2" x 2-1/2" and (42) 1" x 1-1/2" rectangles.</p> <p>(3) 3-1/2" x WOF strips; subcut (84) 1-1/2" x 3-1/2" rectangles.</p> <p>(5) 2" x WOF strips; subcut (126) 1-1/2" x 2" rectangles.</p>
B		53969-1 Night INCLUDES BINDING	2-7/8	<p>PIECED BLOCKS (7) 3-1/2" x WOF strips; subcut (84) 2" x 3-1/2" and (84) 1" x 3-1/2" rectangles.</p> <p>(15) 2-1/2" x WOF strips; subcut (42) 2-1/2" x 7-1/2" and (42) 2-1/2" x 5-1/2" rectangles.</p> <p>(4) 2" x WOF strips; subcut (84) 1" x 2" rectangles and (42) 2" squares.</p> <p>(1) 1" x WOF strip; subcut (42) 1" squares.</p> <p>BINDING: (8) 2-1/4" x WOF strips.</p>
C		38934M-2 Silver Metallic	1-7/8	<p>OUTER BORDER: (7) 3-1/2" x WOF strips. Piece strips and subcut (2) 3-1/2" x 69-1/2" and (2) 3-1/2" x 65-1/2" strips.</p> <p>SASHING STRIPS: (9) 1-1/2" x WOF strips. Piece strips and subcut (6) 1-1/2" x 59-1/2" strips.</p> <p>SASHING RECTANGLES: (9) 1-1/2" x WOF strips; subcut (35) 1-1/2" x 9-1/2" rectangles.</p>

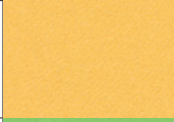
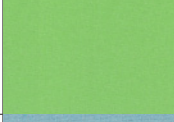

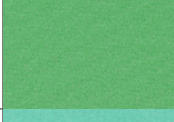
Prismetallic

WOF = WIDTH OF FABRIC

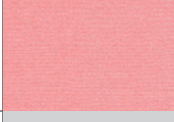
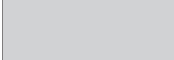
KEY	FABRIC	SKU	YD	CUTTING INSTRUCTIONS
D		53969-12 Sunshine	1/3	PIECED BLOCKS (1) 3-1/2" x WOF strip; subcut (5) 3-1/2" squares. (2) 2" x WOF strips; subcut (40) 2" squares.
E		53969-11 Marigold		
F		53969-27 Fern		
G		53969-22 Bluebird		
H		53969-26 Leaf	1/3	PIECED BLOCKS (1) 3-1/2" x WOF strip; subcut (6) 3-1/2" and (8) 2" squares. (2) 2" x WOF strips; subcut (40) 2" squares.
I		53969-29 Caribbean		
J		53969-9 Cherry	1/4	PIECED BLOCKS (1) 3-1/2" x WOF strip; subcut (4) 3-1/2" and (12) 2" squares. (1) 2" x WOF strip; subcut (20) 2" squares.
K		53969-14 Violet		
L		53969-17 Petal	1/4	PIECED BLOCKS (1) 3-1/2" x WOF strip; subcut (2) 3-1/2" and (16) 2" squares.
		Backing	4-5/8	73" x 83" piece of batting.



Prismetallic

PIECED BLOCK

STAR UNIT

- Flying Geese Unit:** Draw a diagonal line on the wrong side of (1) **J** 2" square. Place square, right sides together (RST), at a corner of (1) **B** 2" x 3-1/2" rectangle. Sew on drawn line. Trim 1/4" away from sewn line. Open and press to reveal **J** corner triangle. Repeat with another **J** square at the opposite corner of the same **B** rectangle to make (1) flying geese unit. Make (2).



- Pieced Rectangle Unit:** Sew together (1) **A** 1-1/2" x 3-1/2" rectangle and (1) **B** 1" x 3-1/2" rectangle, along the long sides, to make a 2" x 3-1/2" pieced rectangle unit.

- Striped Flying Geese Unit:** Repeat Step 1 using (2) **J** 2" squares and (1) Pieced Rectangle Unit. Make (2).



- Sew (1) striped flying geese unit and (1) flying geese unit to the left and right sides, respectively, of (1) **J** 3-1/2" square to make a row unit.

- Sew together (1) **A** 1-1/2" x 2" rectangle and (1) **B** 1" x 2" rectangle, as shown, to make a pieced square unit. Make (2).

- Add (1) pieced square unit to the left of (1) flying geese unit, followed by (1) **B** 2" square to the right of the flying geese unit.

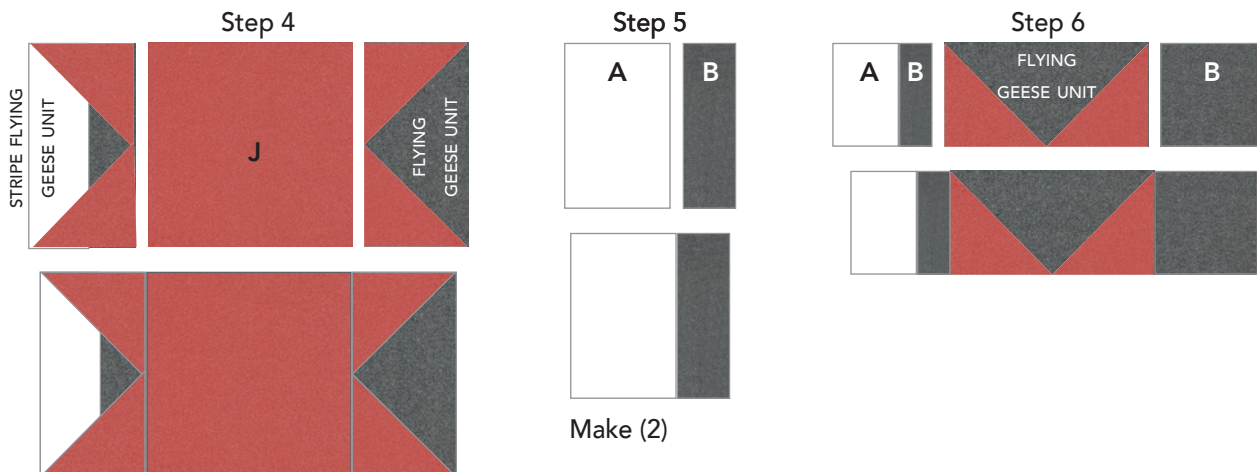



Prismetallic

7. Sew together (1) **B** 1" square and (1) **A** 1" x 1-1/2" rectangle, and add to the top of (1) **A** 1-1/2" x 2" rectangle to make a pieced corner unit.

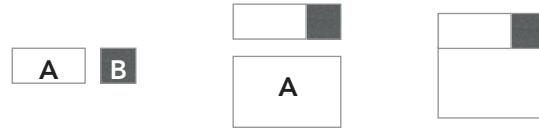

8. Sew (1) pieced corner unit and (1) pieced square to the left and right sides of (1) stripe flying geese unit.

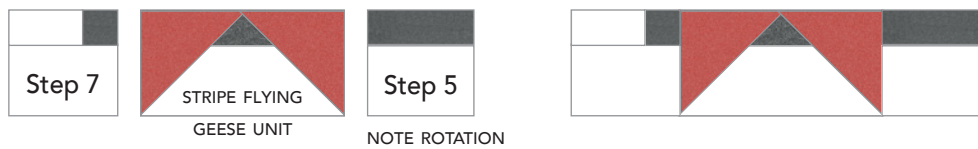

9. Sew together units made in Steps 4, 6 and 8 to make a Star Unit.

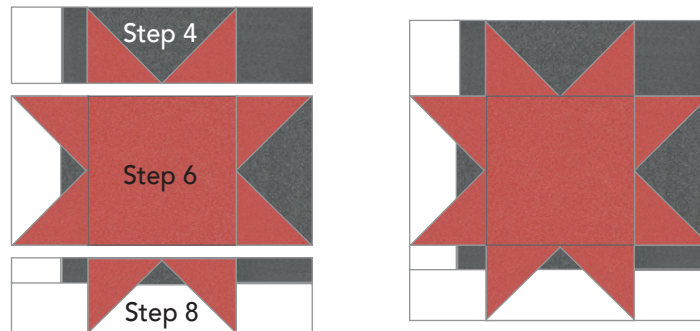

10. Sew together (1) **A** 1-1/2" x 2-1/2" rectangle and (1) **B** 2-1/2" x 5-1/2" rectangle, and add to the right of Star Unit made from Step 9.

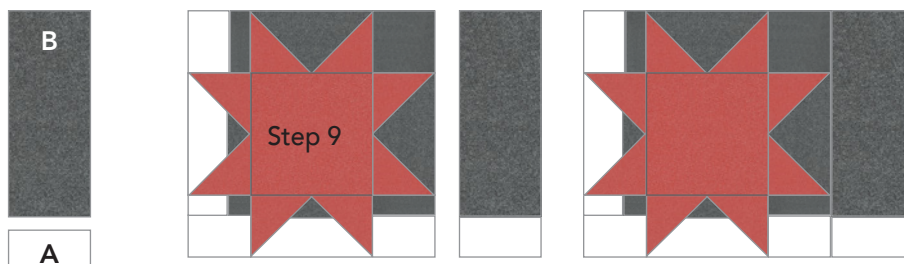



Prismetallic

11. Sew together (1) **A** 1-1/2" x 2-1/2" rectangle and (1) **B** 2-1/2" x 7-1/2" rectangle, and add to the top of Star Unit.

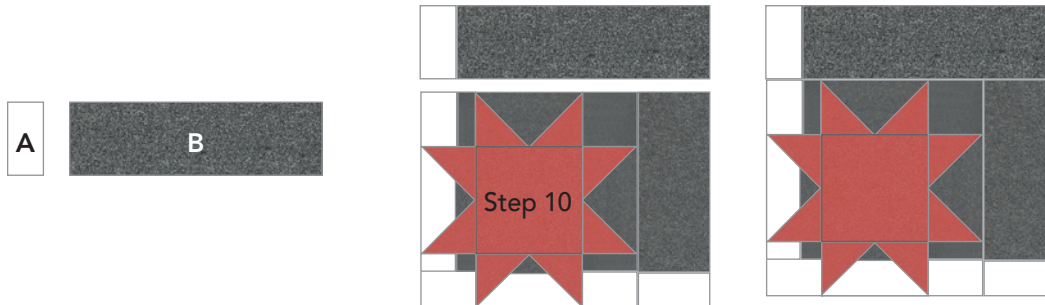

12. Sew (1) **A** 1-1/2" x 8-1/2" rectangle to the right and (1) **A** 1-1/2" x 9-1/2" rectangle to the top of Star Unit made in Step 11 to complete (1) Pieced Block. Measures 9-1/2" square unfinished. Make (4).

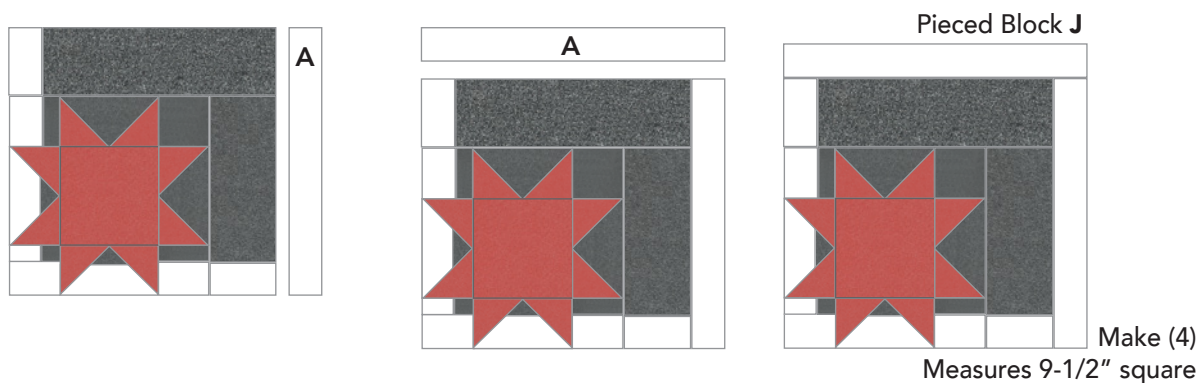

13. Using fabrics **A** and **B**, make the indicated number of blocks for each of the following colorways:

Make (2)



Make (5) of each.

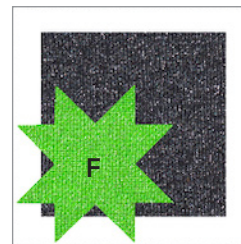
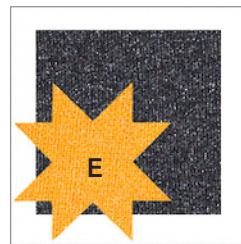

Make (4)

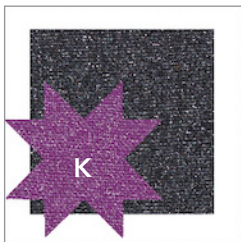

Make (6) of each.

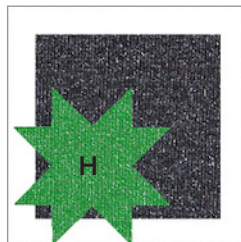



Prismetallic

QUILT CENTER ASSEMBLY

REFER TO QUILT DIAGRAM ON PAGE 8 FOR BLOCK PLACEMENT AND ROTATION.

14. Pieced Rows: Arrange and sew together (6) Pieced Blocks and (5) C 1-1/2" x 9-1/2" sashing rectangles. Make (7).
15. Sew together pieced rows and (6) C 1-1/2" x 59-1/2" sashing strips to complete quilt center.
Rows 1 and 2 are shown below.

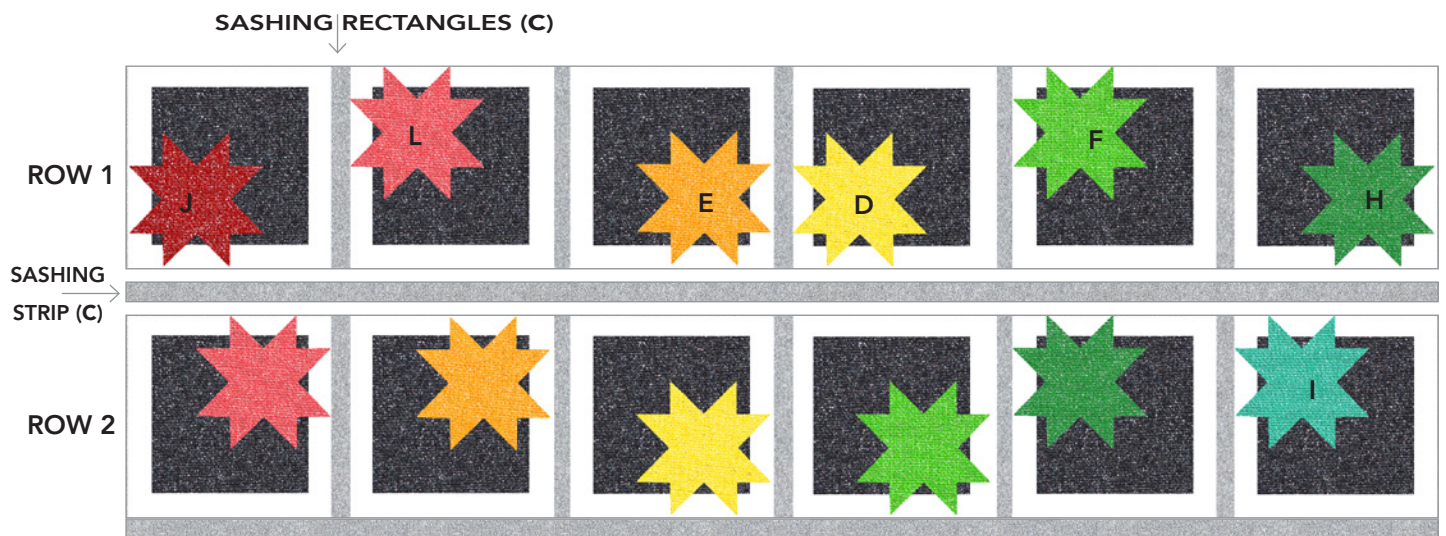

OUTER BORDER

16. Sew (2) C 3-1/2" x 69-1/2" strips to the left and right sides of quilt center, followed by (2) C 3-1/2" x 65-1/2" strips to the top and bottom of quilt center.



Prismetallic

QUILT DIAGRAM

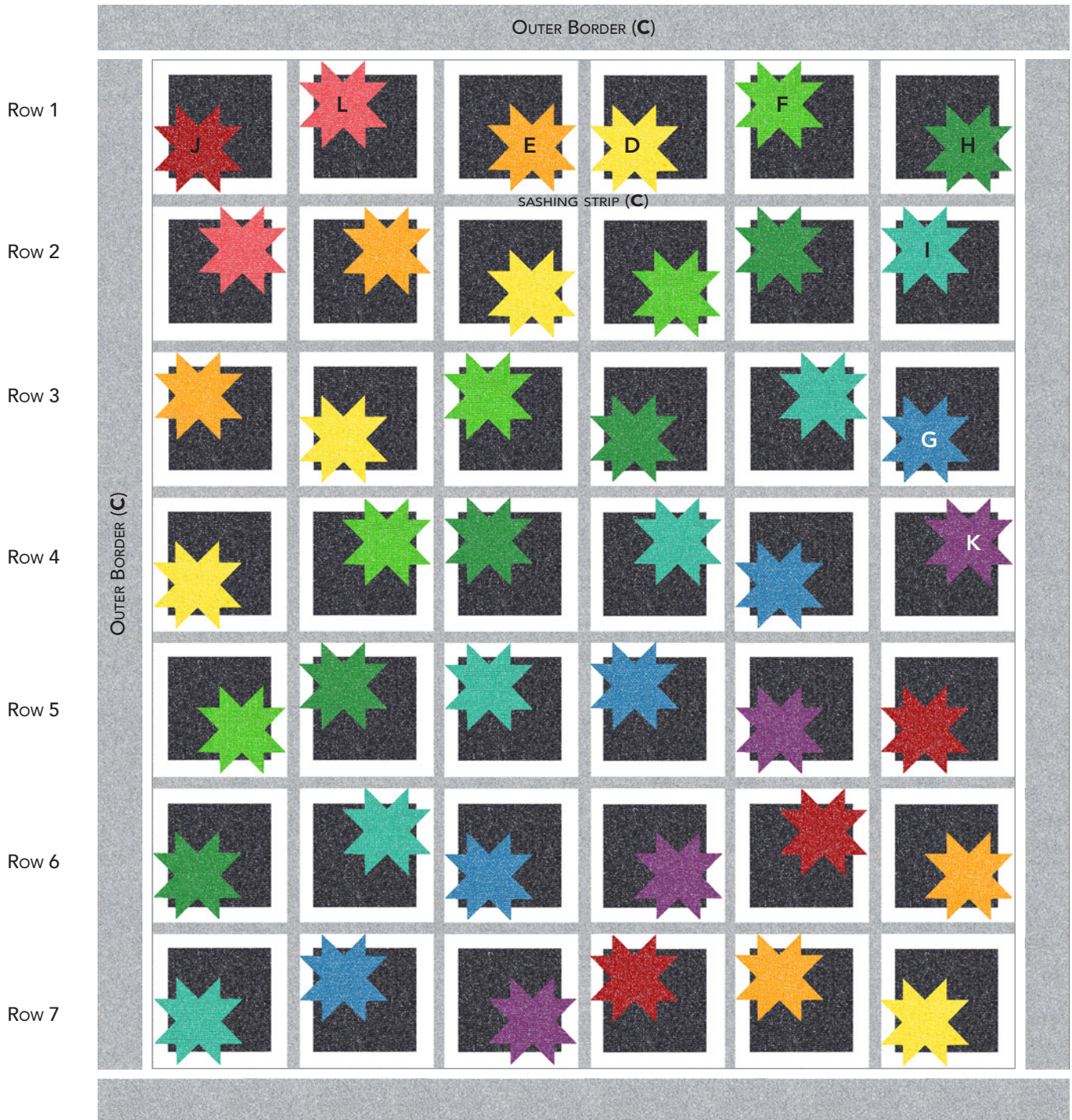

FINISHING: Layer quilt top, batting and backing together to form quilt sandwich. Baste and quilt as desired. Bind using **B** 2-1/4" strips.